

PD-525 MECHANICAL ROOM FLOOD DOOR

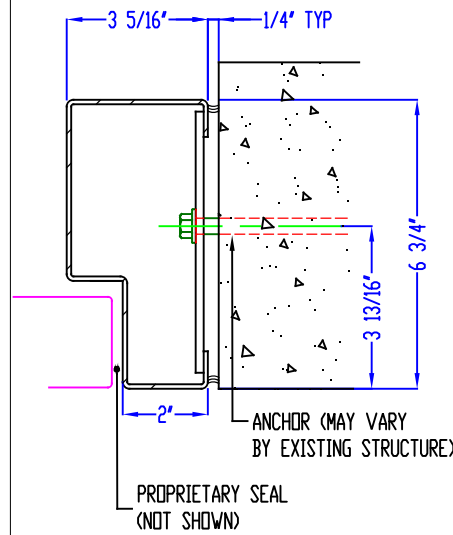

DETAIL C
JAMB DETAIL ②④

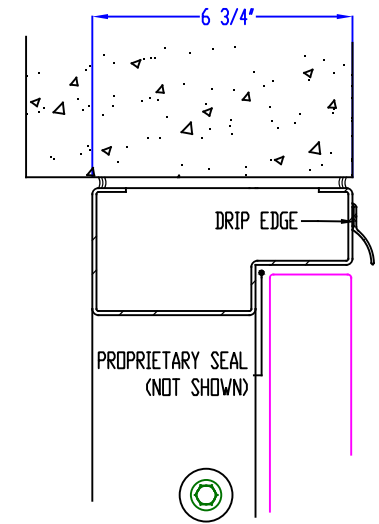

DETAIL E
HEAD DETAIL ②④

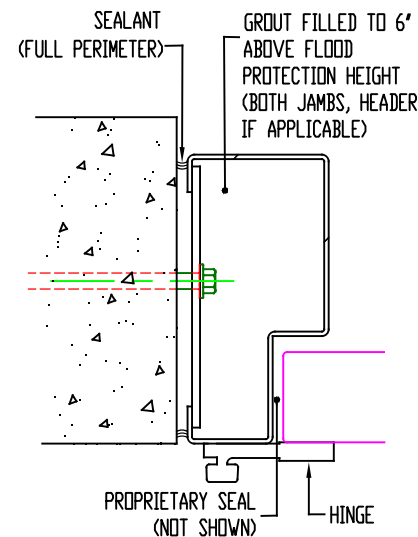

DETAIL D
JAMB DETAIL ②④

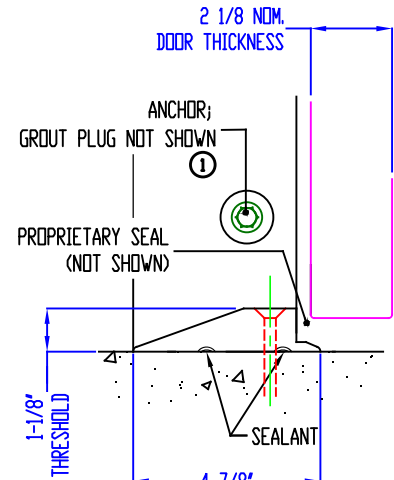

DETAIL F
SILL DETAIL

PROPRIETARY AND CONFIDENTIAL DRAWINGS ARE EXCLUSIVE PROPERTY OF PRODUCTION SPECIALTIES CORPORATION, dba PS DOORS AND CANNOT BE USED IN WHOLE OR PART WITHOUT WRITTEN CONSENT © 2017 PS DOORS ALL RIGHTS RESERVED

- ① LOCATION AND QUANTITY OF ANCHORS TBD BASED ON LOADING
- ② DESIGN SHOWN REQUIRES STRUCTURE TO BE A MINIMUM OF 8" GROUT FILLED CMU OR 3000 PSI CIP; CONTACT PS DOORS FOR DEVIATIONS
- ③ STANDARD LATCHING HARDWARE; 2-PT WEDGE LATCH
- ④ FLOOD LOADS ON DOOR ASSEMBLY ARE TRANSFERRED TO BUILDING STRUCTURE

MODEL: PD-525

DATE: 05/19/2017

**REFERENCE DRAWING
NOT FOR CONSTRUCTION**

SCALE: NTS

SHEET #: 1 OF 1

DWG BY: PS DOORS

REV: C

PS DOORS
 1150 S 48th ST
 GRAND FORKS, ND 58201
 PH. 701-746-4519
 FAX 701-746-8340
 psdoors.com