



EDGEHALT® PAIRED LADDER SAFETY GATE (LSGDBL)

A GATE THAT'S RIGHT WHEN SPACE IS TIGHT

There's nothing more important than your employees' safety. When they use a ladder in your facility, they are at risk of falling. You can help to protect them from accidental falls by installing the proven protection of the ANSI- and OSHA-compliant EdgeHalt® Paired Ladder Safety Gate from PS Safety Access™. This self-closing swing gate provides 42" top- and mid-rail protection, minimizing the chance of a fall on elevated platforms, mezzanines or ladder ways. **Plus, it's perfect for spaces where there is little room for standard swing gates.**

IMPROVES SAFETY:

- Protects personnel from accidental falls from ladder ways, stairwell openings, scaffolding, catwalks, mezzanines and other elevated working platforms
- Self-closing and always in place
- Engineered and tested to comply with OSHA Standards 1910.28 and 1910.29, as well as ANSI A1264.1-2007 and A14.3-2008

EASY AND CONVENIENT INSTALLATION:

- Ships fully assembled, including standard mounting hardware

DURABLE AND VERSATILE CONSTRUCTION:

- Adjustable to fit most openings from 18" to 52-1/2"
- Stainless steel torsion springs

ADDITIONAL OPTIONS:

- Stand-Off Mounting System creates a landing space for personnel to transition more easily through the ladder safety gate

AVAILABLE IN THREE FINISHES:

Powder Coat Yellow (PCY)
Hot Dipped Galvanized (GAL)
304 Stainless Steel (SS)

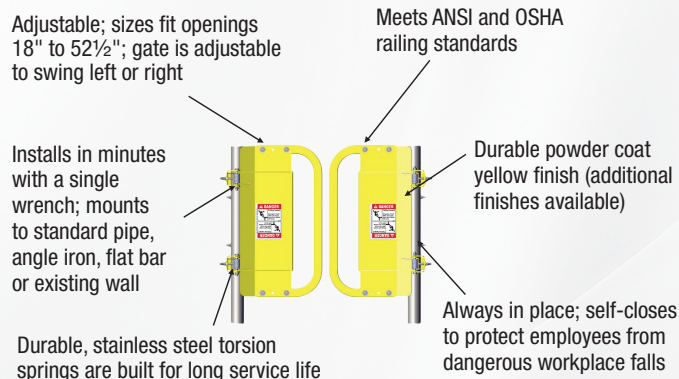

Additional Ladder Safety Gate Options



Stand-Off
Mounting System



EdgeHalt®
Full Height
Ladder Safety Gate



EdgeHalt® Ladder
Safety Gate

STANDARD TECHNICAL DATA

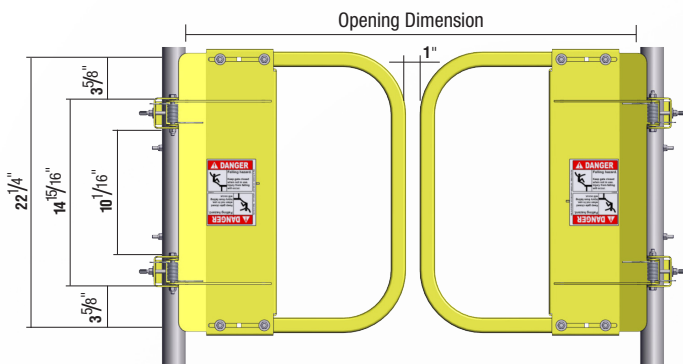

MEASURING GUIDE:

Product Number	Fits Opening Dimension	
	Min	Max
LSGDBL-9	18"	22-1/2"
LSGDBL-12	22"	28-1/2"
LSGDBL-15	28"	34-1/2"
LSGDBL-18	34"	40-1/2"
LSGDBL-21	40"	46-1/2"
LSGDBL-24	46"	52-1/2"

INSTALLATION (standard round pipe or square tube):

The gate ships fully assembled, including standard mounting hardware for round pipe (up to 2" O.D.) and square tubing (up to 1-1/2" x 1-1/2" O.D.); if mounting to angle iron, flat bar or nonstandard railing, gate bolts directly to railing (hardware not included)

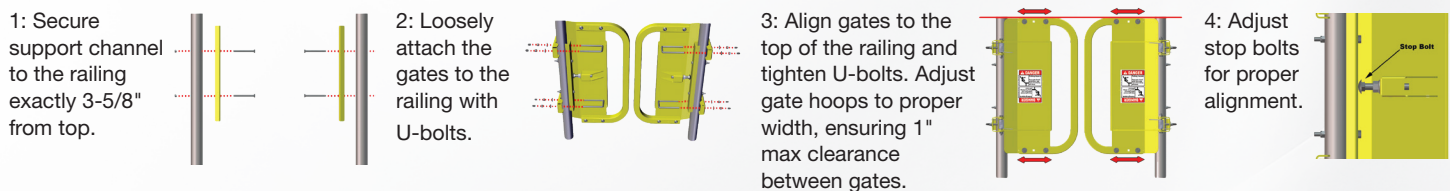

MATERIAL:

- Gate: 1-1/4", 11-gauge* square tubing; minimum dimension from top of gate arm to bottom of gate arm is 22-1/4"
- Hinge Plate: 10-gauge, full height of gate; hinge plate provides for gate adjustment of 3-3/4" (-) 1-1/4" to (+) 2-1/2"
- Gate Operation: Allows for 180° travel; gate swing is reversible by inverting or rotating
- Packaging: Carton includes two gates, standard mounting hardware and Installation/O&M Manual

*Aluminum, 0.125" wall thickness; stainless steel, 16-gauge

HARDWARE:

- Standard Hardware: U-bolts, flat washers, nuts and plastic thread protector cap
- Springs: torsion type, stainless steel; minimum of two (2) springs per gate, housed within hinge pivot

FINISHES:

- Mild steel, powder coat yellow; hardware to be zinc-plated
- Mild steel, hot dip galvanized; hardware to be zinc-plated
- Stainless steel, 304-2b, unpainted; hardware to be stainless type 316