



**Self-Closing**



**Personnel Fall Protection**

# PALLET RACK SAFETY GATE

## SELF-CLOSING FOR ULTIMATE PERSONNEL PROTECTION

The Pallet Rack Safety Gate is a self-closing, dual-gate system designed to fit existing rack systems. After palletized material is forklifted through the gate opening, the spring-loaded system self-closes along the mezzanine edge, protecting personnel from dangerous falls. This gate system is ideal for elevated pick modules with pallet flow systems, elevated working platforms and mezzanines.

### EASY TO OPERATE

- Dual-gate system is always in place, allowing one-way pallet flow while protecting employees from the mezzanine edge
- Gate self-closes by spring-loaded hinge
- Available in standard sizes to fit 60-inch-wide and 96-inch-wide openings (custom sizing available)

### IMPROVES SAFETY

- Complies with OSHA Standards 1910.28 and 1910.29, including a 42-inch-high gate and mid-rail
- Protects personnel on elevated working platforms from accidental falls

### QUICK INSTALLATION

- Universal mounting brackets are compatible with any existing rack system and install in just minutes
- No drilling required – gates bolt on to racking system

### LONG-LASTING AND ECONOMICAL

- Durable mild steel gate construction with powder coat safety yellow finish
- Stainless steel torsion springs are ideal for repetitive use
- Requires little or no maintenance
- Economical cost

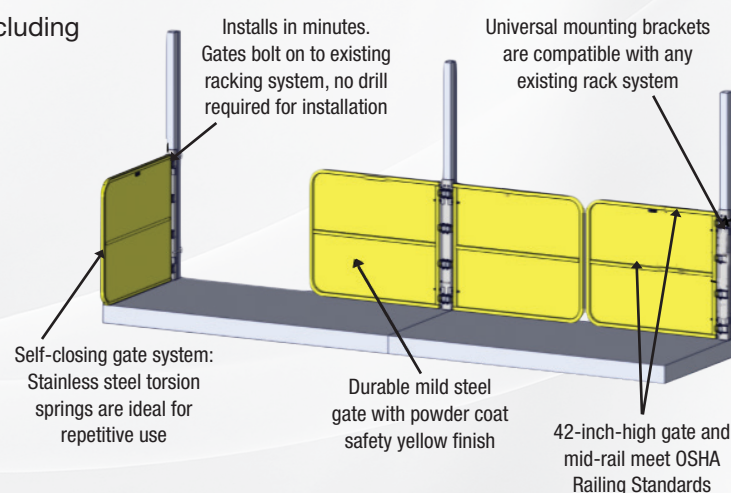

## STANDARD TECHNICAL DATA

### MATERIAL:

- Standard Dimensions: 60" or 96" opening width
- Gate: Formed 1-1/4" square, 11-gauge steel tubing; 18-gauge mild steel sheeting factory welded in place; includes two (2) 3/8" stop bolts, zinc-plated
- Hinge Post: 10-gauge mild steel
- Torsion Springs: 17-7 stainless steel torsion springs ensure safe and consistent operation; includes eight (8) torsion springs per gate system
- Gate Operation: Allows for 90° travel

### HARDWARE:

- Standard mounting hardware includes zinc-plated U-bolts, washers and nuts

### FINISH:

- Finish on all exposed surfaces to be powder coat safety yellow

### PERFORMANCE RATING:

- Engineered and tested to comply with OSHA Standards 1910.28 and 1910.29, relative to guarding openings, at the time of manufacture

### INSTALLATION:

1: Attach mounting bracket to existing racking system at desired height. Secure gate to rack post using U-bolts

2: Adjust stop bolts for proper gate alignment

3: Repeat steps 1 and 2 for additional gates

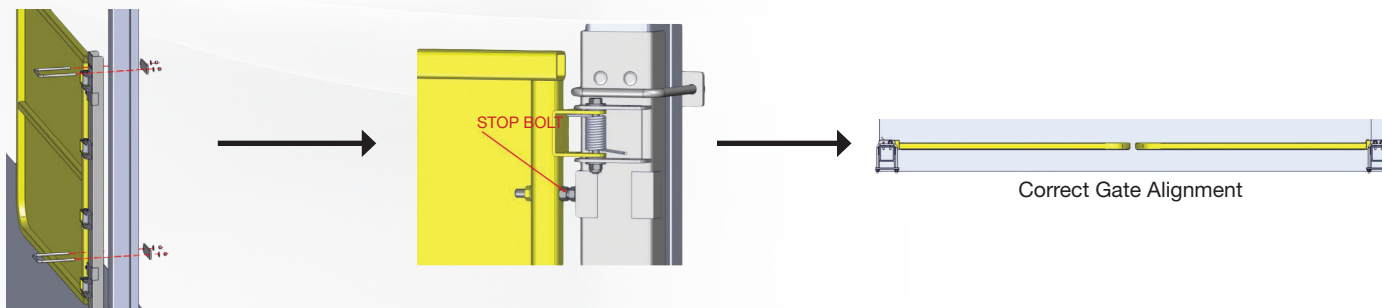

### MEASURING GUIDE:

Model Number	Clear Opening (A)	Opening Width (B)	Gate Width (C)	Gate Height (D)
PRG-60	58-1/4"	60"	30"	42"
PRG-96	94-1/4"	96"	48"	42"

\*Multi-bay configurations utilize shared mounting bracket.

