

HATCHSAFE®



Installation Instructions/Operation and Maintenance Manual



Models:

Rev. C Models

Table of Contents:

| | |
|----------------------------------|----|
| Safety Precautions | 2 |
| Product Information | 2 |
| Operation | 4 |
| Installation Instructions | 5 |
| Replacement Parts List | 10 |
| Inspection and Maintenance | 12 |
| Warranty Certificate | 15 |

Contact Information

Mail

PS Access Solutions
1150 South 48th Street
Grand Forks, ND 58201

Local Phone

701.746.4519

Website

psaccesssolutions.com

Hours of Operation

8 A.M. to 5 P.M. CT
Monday – Friday

Toll Free Phone

877.446.1519

Email

4psinfo@psindustries.com

IMPORTANT! Read entire Instruction and Operations Manual to become familiar with the product.

NOTICE This product is a commercial product. The effectiveness of the product is directly related to the proper installation and operation of this product. Failure to properly maintain this product **will** affect performance.

Publication Notice

This manual has been compiled and published covering the latest product descriptions and specifications.

The contents of this manual and the specifications of this product are subject to change without notice.

PS Access Solutions™ reserves the right to make changes without notice in the specifications and materials contained herein and shall not be responsible for any damages (including consequential) caused by reliance on the materials presented, including but not limited to typographical and other errors relating to the publication.

PS Access Solutions and/or its respective suppliers may make improvements and/or changes in the product(s)/ service(s) offered and/or the program(s) at any time without notice.

Retain this manual for future reference.

If you would like to download a copy of this manual, please go to psaccesssolutions.com

Product registration is an essential step to protecting your product, register Online at psindustries.com/contact/register-your-product/



Safety Precautions

The following icons are used throughout this Manual.

- ▲ DANGER** Indicates an imminently hazardous situation which, if not avoided, will result in death or serious injury.
- ▲ WARNING** Indicates a potentially hazardous situation which, if not avoided, could result in death or serious injury.
- ▲ CAUTION** Indicates a potentially hazardous situation which, if not avoided, may result in minor or moderated injury.
- NOTICE** Indicates manufacturer's statement of additional information.
- IMPORTANT!** Indicates a required action.
- CRITICAL** Indicates a vital component to product performance.

Product Information

NOTICE Unauthorized modification of or to the Product voids this Limited Warranty. Authorized modifications, received in writing from PS Industries® Incorporated, as long as the modification is accomplished in strict accordance with PS Industries' instructions, does not void warranty. If this product is modified or altered without manufactures permission, manufacturer is no longer responsible for the product design, engineering, or performance and owner assumes all responsibility. To request product modifications contact PS Industries Incorporated, 1150 S. 48th Street, Grand Forks, ND 58201, phone 877-446-1519, email: 4psinfo@psindustries.com

I. General Information

- A. This manual contains information regarding installation, operation, and maintenance of the PS Access Solutions' HatchSafe®.
- B. The HatchSafe® is designed to meet OSHA Railing Standard 1910.29, ANSI 1264.1-2017, Canada OHS SOR-86-304 PART II, ANSI ASC A14.3-2008.
- C. PS Access Solutions recommends that the owner implement a regular maintenance program to inspect the HatchSafe® as necessary.

II. Operation Guidelines

- A. Operation in a manner other than intended could result in damage or less than acceptable performance at time of need, for which the manufacturer will not be held responsible.

III. Safety Precautions

- A. Ensure opening is clear of all obstructions or debris.
- B. Comply with all OSHA and ANSI Safety Regulations and/or company safety policies when installing.
- C. Install only on surfaces capable of supporting all loading.

▲ DANGER Ensure installation area is blocked off from personnel during installation, and mounting surface is capable of supporting all loading. Structural analysis of mounting surface is the responsibility of the owner.

IV. Storage Prior to Installation of Product

- A. Store materials in a dry, ventilated location. If outdoor storage is required, block materials and tarp in a tent-like arrangement, elevated above the product with open sides to allow airflow.

V. Installation Site Preparation

NOTICE Before starting site preparation and installation of the PS Access Solutions' HatchSafe®, read the entire Operation and Maintenance Manual and review all installation instructions thoroughly.

- A. Clear work area of any debris.
- B. Ensure you have the necessary tools available. *See page 3 for recommended tools.
- C. Obtain all required permits.
- D. Personnel: Determine the appropriate number of personnel required to perform installation and have them readily available at the project site (1-2 people recommended).

Product Information

VI. HatchSafe® Part List

A. Review inventory to ensure all parts are present for assembly/installation. Refer to part list below.

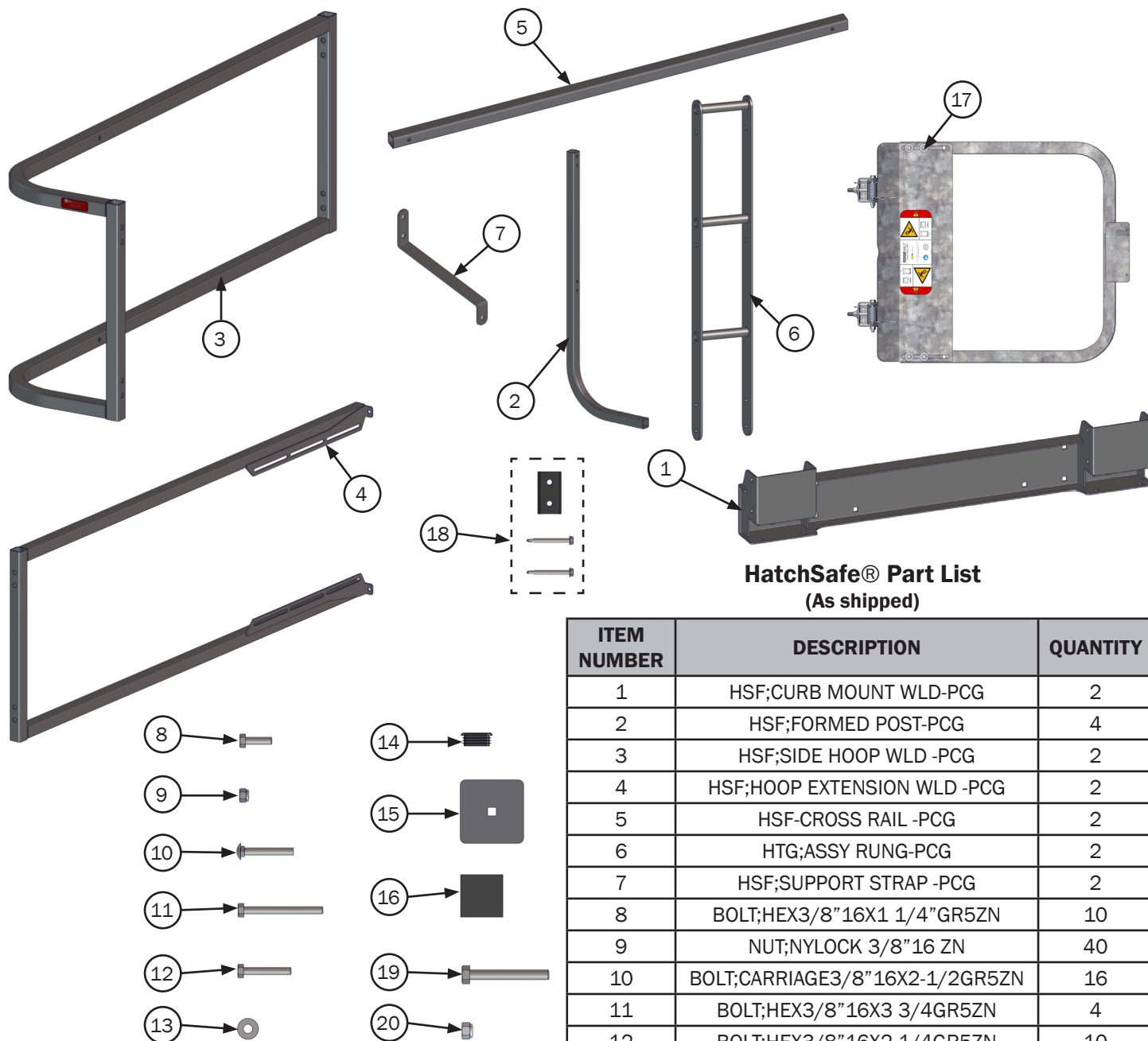

HatchSafe® Part List
(As shipped)

| ITEM NUMBER | DESCRIPTION | QUANTITY |
|-------------|--------------------------------|----------|
| 1 | HSF;CURB MOUNT WLD-PCG | 2 |
| 2 | HSF;FORMED POST-PCG | 4 |
| 3 | HSF;SIDE HOOP WLD -PCG | 2 |
| 4 | HSF;HOOP EXTENSION WLD -PCG | 2 |
| 5 | HSF-CROSS RAIL -PCG | 2 |
| 6 | HTG;ASSY RUNG-PCG | 2 |
| 7 | HSF;SUPPORT STRAP -PCG | 2 |
| 8 | BOLT;HEX3/8"16X1 1/4"GR5ZN | 10 |
| 9 | NUT;NYLOCK 3/8"16 ZN | 40 |
| 10 | BOLT;CARRIAGE3/8"16X2-1/2GR5ZN | 16 |
| 11 | BOLT;HEX3/8"16X3 3/4GR5ZN | 4 |
| 12 | BOLT;HEX3/8"16X2 1/4GR5ZN | 10 |
| 13 | WASHER;FLAT 3/8"ZN | 12 |
| 14 | CAP;SQ,BLK PLASTIC, 1.5" O.D. | 14 |
| 15 | HTG; CRUSH PLATE-PCG | 8 |
| 16 | WS;CURB/CRUSH PLT WEATHER SEAL | 8 |
| 17 | LADDER SAFETY GATE (LSG)* | 1 |
| 18 | LSG;SUPPORT BLOCK KIT** | 1 |
| 19 | BOLT;HEX1/2"13X3 3/4GR5ZN | 8 |
| 20 | NUT;NYLOCK 1/2"13ZN | 8 |

Recommended Tools:

1. Two (2) 9/16" Wrenches
2. One (1) 1 1/2" Wrench
3. One (1) Electric Drill
4. One (1) 7/16" Drill Bit
5. One (1) Tape Measure
6. One (1) Level
7. One (1) Nut Driver
8. One (1) Rubber Mallet

* Ladder Safety Gate comes pre-assembled.

** For models HSF-48 only.

Operation

NOTICE Operation in a manner other than intended could result in damage or less than acceptable performance at time of need for which the manufacturer will not be held responsible.

VII. Operation

A. HatchSafe® (See Illustration A)

1. The HatchSafe® is a full permanent railing system with a self-closing gate and integrated grab bars. This product is designed specifically for Roof Hatch openings.

B. HatchGrip® Grab Bars (See Illustration B)

1. The HatchSafe® railing system has integrated horizontal grab bars which are intended to assist in ascending and descending the ladder

C. Ladder Safety Gate (See Illustration C)

1. Self-closing Ladder Safety Gate is attached to the full hatch railing system to protect roof opening and allow safe access to the hatch.
2. DO NOT USE THE LADDER SAFETY GATE AS A GRAB SURFACE.

**Operation
Illustration A**

**Operation
Illustration B**

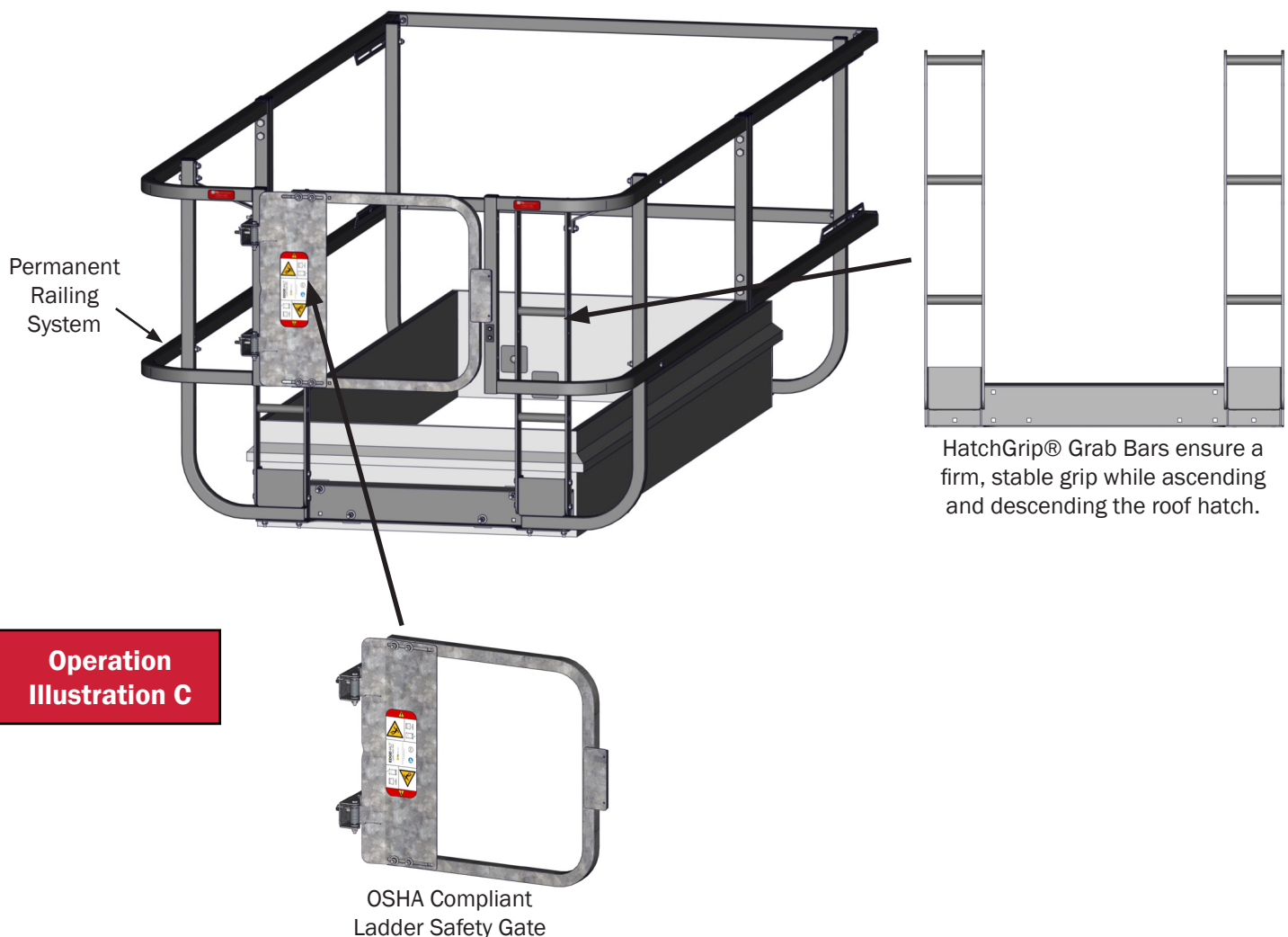

Installation

VIII. HatchSafe® Installation

NOTICE Loosely install all bolts for initial assembly.

- STEP 1.** Install the curb bracket to the hatch curb front, (the side with the ladder).
- Determine the mounting height of the curb bracket (See Illustration A).
 - Square crush plate must be mounted to the interior of the hatch so you will have to allow for clearance.

IMPORTANT! Bottom rung must be higher than the top of the hatch cap flashing (See Illustration A).

- Once height and center have been determined, mark the four holes that will be used while fastening to the existing curb (See Illustration A).

IMPORTANT! Step 1:c MUST be done before fastening curb assembly to existing curb.

- When holes are marked and you have ensured crush plate will fit, match drill holes with a $\frac{7}{16}$ " drill bit to ensure proper alignment.
- Attach the crush plate weatherseal at the anchor locations between curb assembly and existing hatch curb (See Illustration B).
- Fasten curb assembly to front of existing hatch curb using $\frac{3}{8}$ " x 2 $\frac{1}{2}$ " carriage bolt, $\frac{3}{8}$ " washer, and $\frac{3}{8}$ " nylock nut. Trim excess bolt length, if desired.
- Install curb assembly to the rear of the hatch curb at same height (Repeat Step 1:b through Step 1:f).

**Step 1
Illustration A**

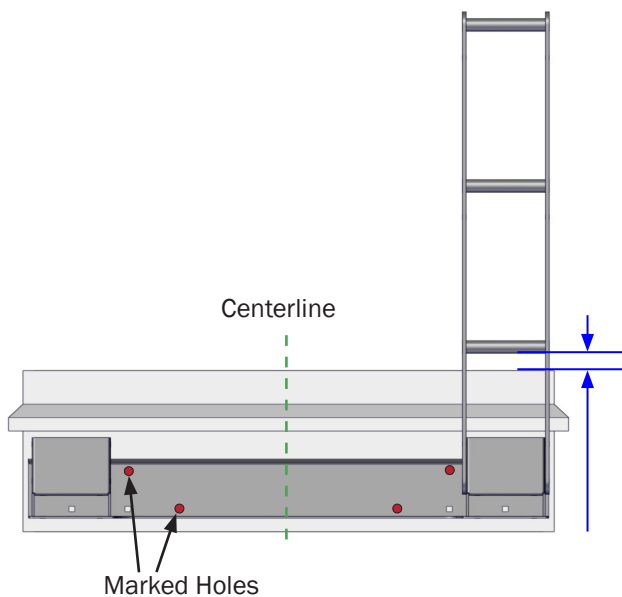

**Step 1
Illustration B**

IMPORTANT! Place the crush plate weatherseals on the back side of the curb bracket with corresponding holes to be used.

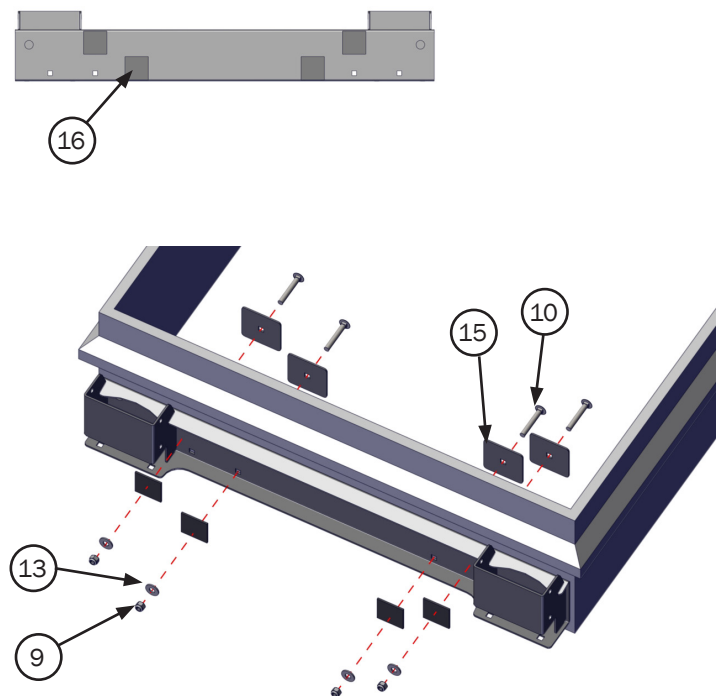

IMPORTANT! Make sure rung is above hatch cap flashing.

Installation

STEP 2. Attaching Vertical Posts.

- a. After the front curb assembly has been mounted, attach the four vertical posts with the provided $\frac{3}{8}$ " x 2 $\frac{1}{2}$ " carriage bolts and $\frac{3}{8}$ " nylock nuts.

Step 2 Illustration

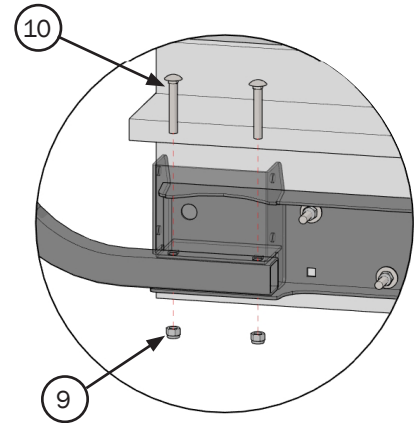
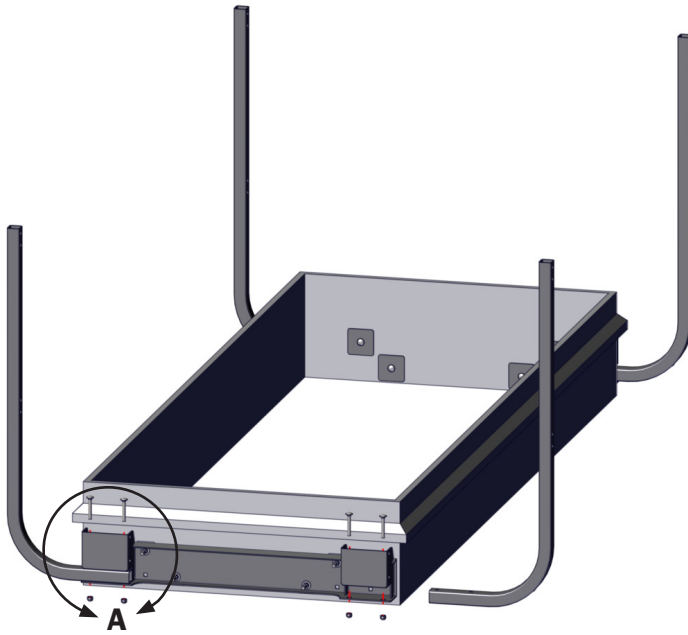

DETAIL A

STEP 3. Attaching HatchGrip®.

- a. Attach the two HatchGrip®s with the provided $\frac{3}{8}$ " x 1 $\frac{1}{4}$ " hex bolts and $\frac{3}{8}$ " nylock nuts.

Step 3 Illustration

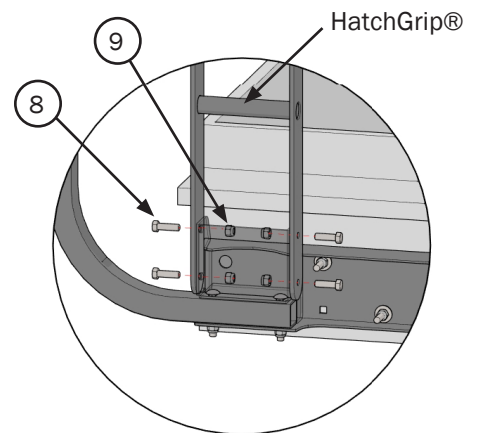
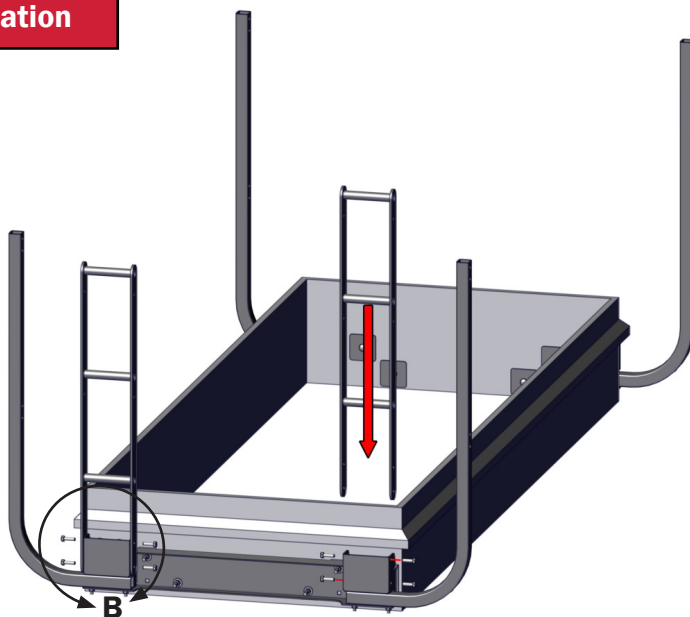

DETAIL B

Installation

STEP 4. Connecting Side Hoop and Hoop Extension.

- Connect the side hoop and hoop extension with the provided $\frac{1}{2}$ " x $3\frac{3}{4}$ " hex bolts and $\frac{1}{2}$ " nylock nuts.

IMPORTANT! Make sure Hatchgrip decals shows correct orientation, front facing on top railing member.

Step 4 Illustration

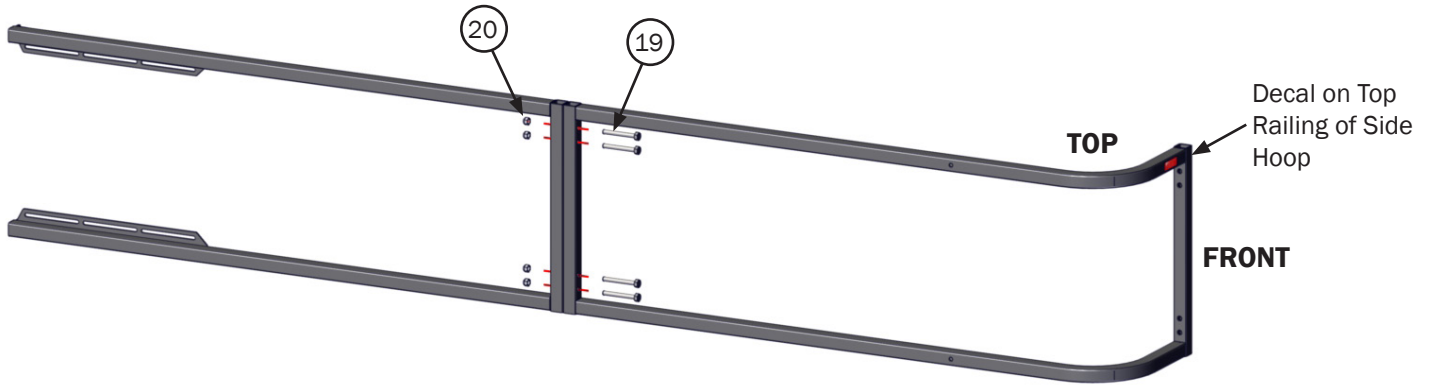

STEP 5. Attaching the Side Hoop to the Vertical Posts.

- Make sure the railing opening will be in front of the HatchGrip® ladder rungs.
- Bolt the bottom rung (opening side) of the railing system to the front vertical post with provided $\frac{3}{8}$ " x $3\frac{3}{4}$ " hex bolt and $\frac{3}{8}$ " nylock nut (See Illustration B).

Step 5 Illustration A



Step 5 Illustration B

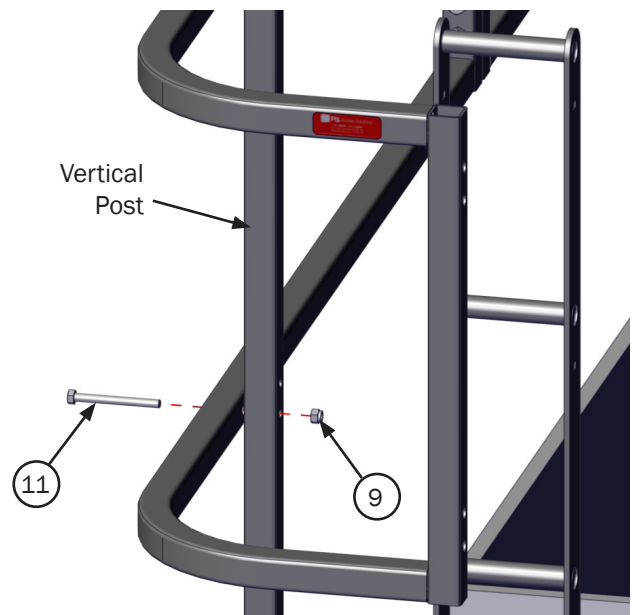

Installation

STEP 6. Attaching the Hoop Extension to the Vertical Posts.

- Attach the hoop extension to the rear vertical post with provided $\frac{3}{8}$ " x $2\frac{1}{4}$ " hex bolts, $\frac{3}{8}$ " flat washers, and $\frac{3}{8}$ " nylock nuts (See Illustration B).

**Step 6
Illustration A**



**Step 6
Illustration B**

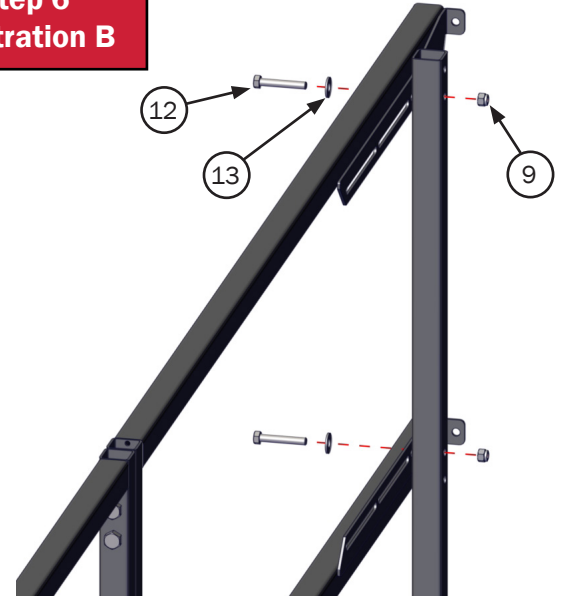

STEP 7. Attaching the Side Hoops and Upper Support Straps to the Vertical Posts.

- Attach the support strap to the HatchGrip® assembly using a $\frac{3}{8}$ " x $1\frac{1}{4}$ " hex bolt and $\frac{3}{8}$ " nylock nut (See Illustration B).
- Attach the support strap to the front formed post using the provided $\frac{3}{8}$ " x $2\frac{1}{4}$ " hex bolt and $\frac{3}{8}$ " nylock nut (See Illustration B).
- Attach the hoop extension to the front formed post and support strap using the provided $\frac{3}{8}$ " x $3\frac{3}{4}$ " hex bolt and $\frac{3}{8}$ " nylock nut (See Illustration B).

**Step 7
Illustration A**

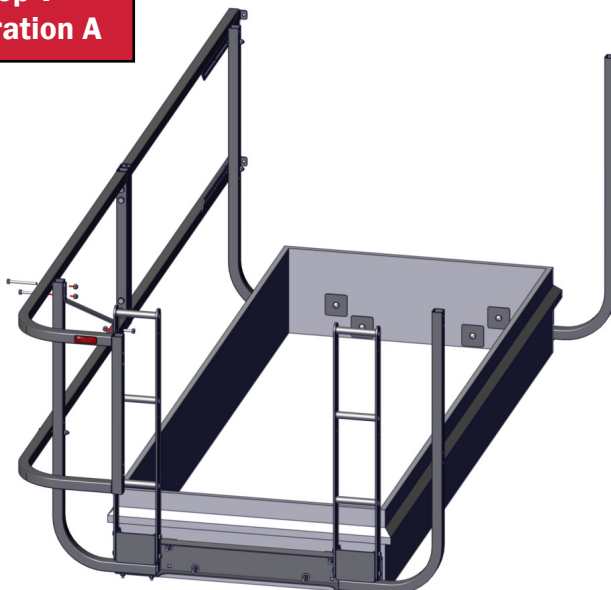

**Step 7
Illustration B**

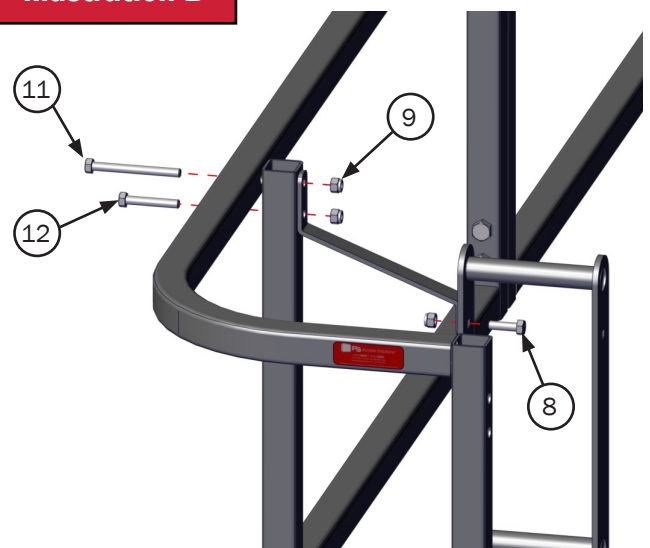

STEP 8. Repeat Step 5 thru Step 7 for opposite Side Hoop and Hoop Extension attachment.

Installation

STEP 9. Attaching the Back Rails.

- Attach the back rails to the railing tabs using the $\frac{3}{8}$ " x 2 $\frac{1}{4}$ " hex bolts and $\frac{3}{8}$ " nylock nuts (See Illustration B).

**Step 9
Illustration A**



**Step 9
Illustration B**

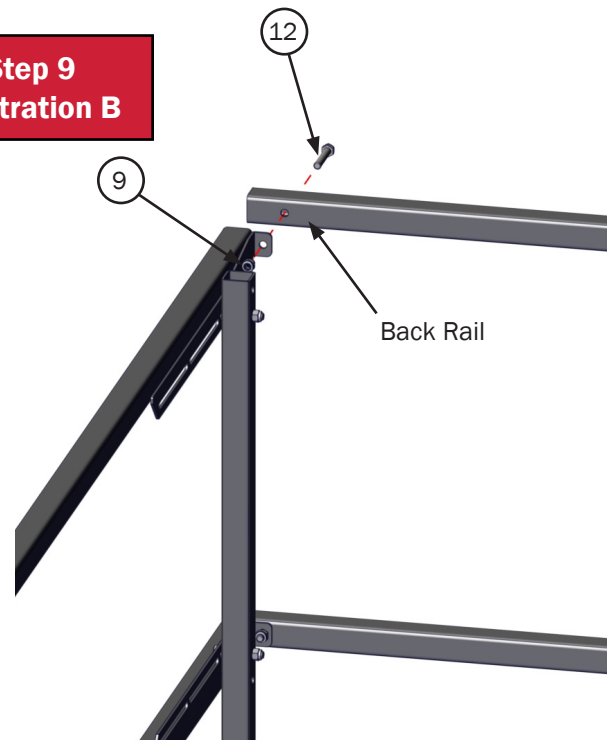

STEP 10. Installing the Black Plastic Caps.

- Using a rubber mallet, install (14) square black plastic caps to the open tube ends in top and sides of HatchSafe®.

STEP 11. Installing the EdgeHalt® Ladder Safety Gate (LSG).

- When all HatchSafe® components are installed and fastened, install the provided Ladder Safety Gate and Support Block Kit.

*See included Ladder Safety Gate O&M Manual for installation instructions.

**Step 11
Illustration**

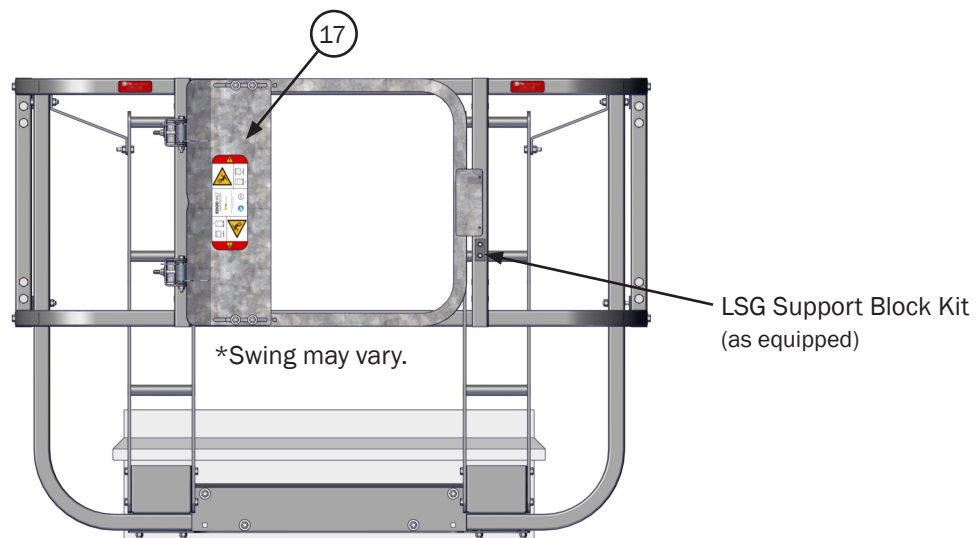

CRITICAL *Tighten all fasteners to a minimum torque of 10 ft-lbs after all components are installed completely.

Replacement Parts List

IX. Replacement Parts List

- A. This Replacement Parts List is for all HatchSafe® Rev C Models.
 B. The Parts Diagram is located on Page 11.

| Hardware Parts List | | | |
|---------------------|--------------------------------|-----|--------|
| ITEM # | DESCRIPTION | QTY | PART # |
| 8 | BOLT;HEX3/8"16X1 1/4"GR5ZN | 10 | 500401 |
| 9 | NUT;NYLOCK 3/8"16ZN | 40 | 501120 |
| 10 | BOLT;CARRIAGE3/8"16X2-1/2GR5ZN | 16 | 500320 |
| 11 | BOLT;HEX3/8"16X3 3/4GR5ZN | 4 | 502934 |
| 12 | BOLT;HEX3/8"16X2 1/4GR5ZN | 10 | 500405 |
| 13 | WASHER;FLAT 3/8"ZN | 12 | 501947 |
| 19 | BOLT;HEX1/2"13X3 3/4GR5ZN | 8 | 502665 |
| 20 | NUT;NYLOCK 1/2"13ZN | 8 | 501123 |

| Finish Options | |
|----------------|------------------|
| PCG | Powder Coat Gray |

*For replacement hardware, order HSF;Hardware Kit (part #514520). Kit includes bolts, nuts, and washers for HatchSafe® Rev C Models.

**TO ORDER PARTS CONTACT PS ACCESS SOLUTIONS AT
 877.446.1519 or 4psinfo@psindustries.com**

| Replacement Parts List for HSF-48 | | | | | | |
|-----------------------------------|--------------------------------|-----|------------|------------|------------|------------|
| ITEM # | DESCRIPTION | QTY | HSF-4848 | HSF-4866 | HSF-4884 | HSF-48102 |
| 1 | HSF;CURB MOUNT WLD-PCG | 2 | 514269 | 514269 | 514269 | 514269 |
| 2 | HSF;FORMED POST 48-PCG | 4 | 514272 | 514272 | 514272 | 514272 |
| 3 | HSF;SIDE HOOP WLD - PCG | 2 | 514284 | 514284 | 514287 | 514289 |
| 4 | HSF;HOOP EXTENSION WLD - PCG | 2 | 514291 | 514295 | 514297 | 514299 |
| 5 | HSF;CROSS RAIL 48-PCG | 2 | 514278 | 514278 | 514278 | 514278 |
| 6 | HTG;ASSY RUNG-PCG | 2 | 500802 | 500802 | 500802 | 500802 |
| 7 | HSF;SUPPORT STRAP 48-PCG | 2 | 514282 | 514282 | 514282 | 514282 |
| 14 | CAP;SQ,BLK PLASTIC, 1.5" O.D. | 14 | 514336 | 514336 | 514336 | 514336 |
| 15 | HTG;CRUSH PLATE-PCG | 8 | 500807 | 500807 | 500807 | 500807 |
| 16 | WS;CURB/CRUSH PLT WEATHER SEAL | 8 | 511040 | 511040 | 511040 | 511040 |
| 17 | LADDER SAFETY GATE GAL 24" | 1 | LSG-24-GAL | LSG-24-GAL | LSG-24-GAL | LSG-24-GAL |
| 18 | LSG;SUPPORT BLOCK KIT | 1 | 503633 | 503633 | 503633 | 503633 |
| 21 | HTC;DECAL HATCH GRIP & SAFE | 2 | 514698 | 514698 | 514698 | 514698 |

| Replacement Parts List for HSF-60 | | | | | | |
|-----------------------------------|--------------------------------|--------------------------|------------|------------|------------|------------|
| ITEM # | DESCRIPTION | QTY | HSF-6048 | HSF-6066 | HSF-6084 | HSF-60102 |
| 1 | HSF;CURB MOUNT WLD-PCG | 2 | 514269 | 514269 | 514269 | 514269 |
| 2 | HSF;FORMED POST 60-PCG | 4 | 514276 | 514276 | 514276 | 514276 |
| 3 | HSF;SIDE HOOP WLD - PCG | 2 | 514284 | 514284 | 514287 | 514289 |
| 4 | HSF;HOOP EXTENSION WLD - PCG | 2 | 514291 | 514295 | 514297 | 514299 |
| 5 | HSF;CROSS RAIL 60-PCG | 2 | 514280 | 514280 | 514280 | 514280 |
| 6 | HTG;ASSY RUNG-PCG | 2 | 500802 | 500802 | 500802 | 500802 |
| 7 | HSF;SUPPORT STRAP 60-PCG | 2 | 514283 | 514283 | 514283 | 514283 |
| 14 | CAP;SQ,BLK PLASTIC, 1.5" O.D. | 14 | 514336 | 514336 | 514336 | 514336 |
| 15 | HTG;CRUSH PLATE-PCG | 8 | 500807 | 500807 | 500807 | 500807 |
| 16 | WS;CURB/CRUSH PLT WEATHER SEAL | 8 | 511040 | 511040 | 511040 | 511040 |
| 17 | LADDER SAFETY GATE GAL 36" | 1 | LSG-36-GAL | LSG-36-GAL | LSG-36-GAL | LSG-36-GAL |
| 18 | LSG;SUPPORT BLOCK KIT | Supplied with LSG-36-GAL | | | | |
| 21 | HTC;DECAL HATCH GRIP & SAFE | 2 | 514698 | 514698 | 514698 | 514698 |

Replacement Parts List

X. Replacement Parts Diagram

A. This Parts Diagram is for all HatchSafe® Rev C Models.

*For replacement hardware, order HSF;Hardware Kit (part #514520). Kit includes bolts, nuts, and washers for HatchSafe® Rev C Models.

TO ORDER PARTS CONTACT PS ACCESS SOLUTIONS AT
877.446.1519 or 4psinfo@psindustries.com

| Finish Options | |
|----------------|------------------|
| PCG | Powder Coat Gray |

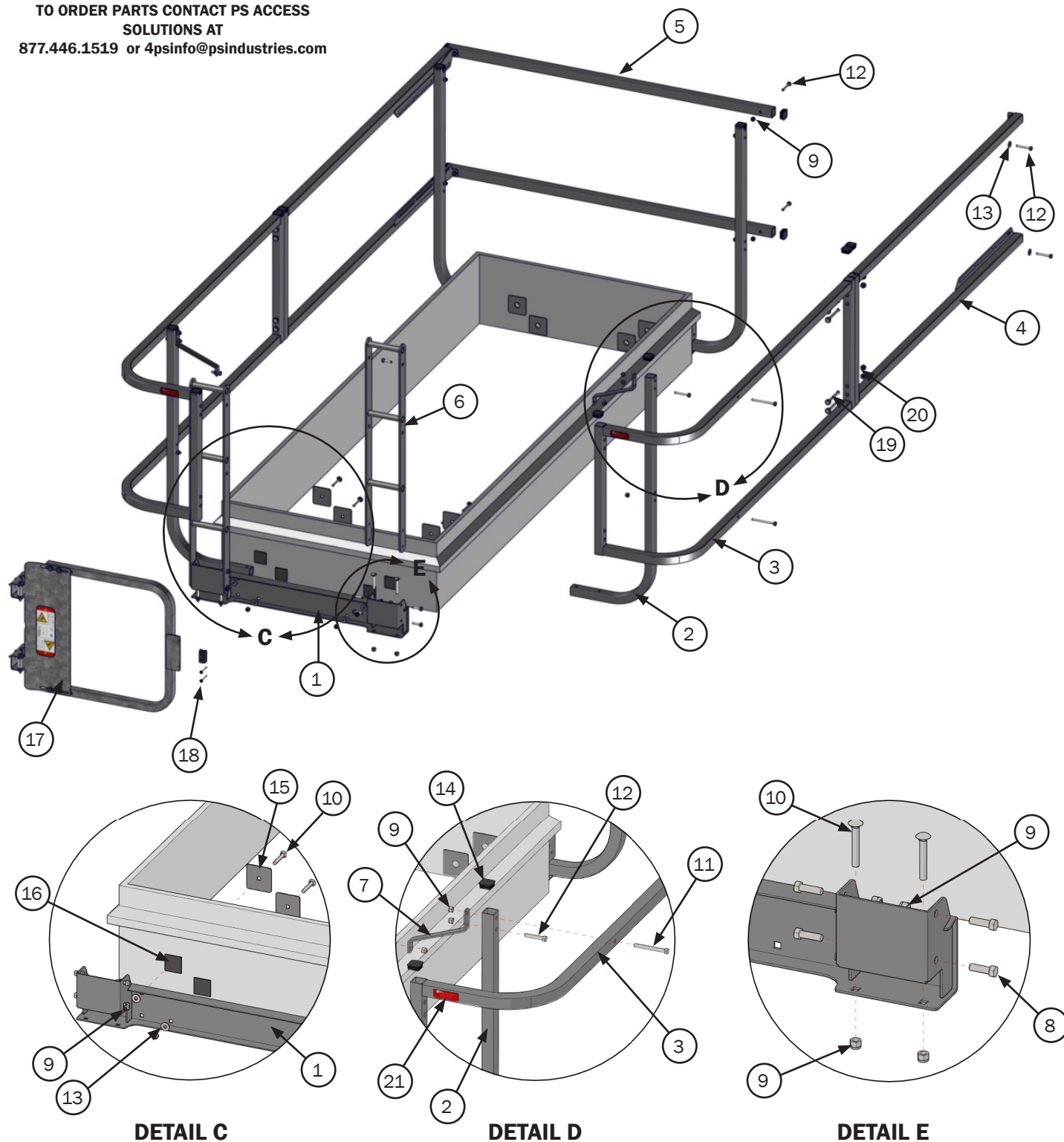

Inspection and Maintenance

XI. Inspection and Maintenance (Minimum Annually)

IMPORTANT! Consult Parts List before replacing fasteners, as all have specific design load requirements. Only use like items for replacement.

A. Railing Assembly:

1. Inspect components for damage and misalignment. Adjust, repair, or replace as needed, to meet original design tolerance.
2. Check black square plastic caps for cracks, replace as necessary.

B. Gate Assembly:

1. Inspect gates for corrosion or damage, repair or replace as necessary.
2. Check gates for proper alignment with catch. Adjust as necessary to achieve proper alignment.

C. Fasteners and mechanical connections:

1. All fasteners must be in place and adjusted to their original design standard, per included anchor manufacturer's technical manual.
2. Check all mounting connections, making sure they meet original design standards (refer to Installation Instructions).
3. Replace any damaged components.

D. Finishes:

1. Inspect all surfaces for signs of wear or corrosion and clean finishes periodically.
2. Touch up repair finishes, or refinish as necessary to protect the structural integrity.
3. The HatchSafe® comes with a polyester powder coat finish. Use finish materials compatible with powder coat. Follow paint manufacturers' instructions for prep and touch-up.

E. Housekeeping:

1. To ensure your product continues to operate and last, upon completion of proper installation, complete the following:
 - a. Clean all surfaces.
 - b. If project is ongoing, protect installed products until final completion of project.
 - c. Touch-up, repair, or replace damaged components.

F. Labels and Placards:

1. Inspect all labels and placards.
2. Replace any labels and placards which are unreadable/missing.

Inspection and Maintenance Log

CRITICAL Periodic Inspection and Maintenance Required. Inspect at minimum annually.

Date Installed:

Product:

Model Number:

Serial Number:

Opening Identifier/ Number:

Location:

| DATE INSPECTED | INSPECTED BY <i>(Print & Sign)</i> | INSPECTION ITEMS NOTED | CORRECTIVE ACTION | CORRECTED BY <i>(Print & Sign)</i> |
|----------------|---|------------------------|-------------------|---|
| | | | | |
| | | | | |
| | | | | |
| | | | | |
| | | | | |
| | | | | |
| | | | | |
| | | | | |
| | | | | |
| | | | | |
| | | | | |
| | | | | |
| | | | | |
| | | | | |
| | | | | |
| | | | | |
| | | | | |
| | | | | |
| | | | | |
| | | | | |

Inspection and Maintenance Log

CRITICAL Periodic Inspection and Maintenance Required. Inspect at minimum annually.

Date Installed:

Product:

Model Number:

Serial Number:

Opening Identifier/ Number:

Location:

| DATE INSPECTED | INSPECTED BY <i>(Print & Sign)</i> | INSPECTION ITEMS NOTED | CORRECTIVE ACTION | CORRECTED BY <i>(Print & Sign)</i> |
|-------------------|---|---------------------------|-------------------|---|
| | | | | |
| | | | | |
| | | | | |
| | | | | |
| | | | | |
| | | | | |
| | | | | |
| | | | | |
| | | | | |
| | | | | |
| | | | | |
| | | | | |
| | | | | |
| | | | | |
| | | | | |
| | | | | |
| | | | | |
| | | | | |
| | | | | |
| | | | | |

PS INDUSTRIES® INCORPORATED – LIMITED WARRANTY

Limited Warranty: Subject to the terms of this Limited Warranty, PS Industries® Incorporated warrants to the original user or consumer (the "Owner") of a PS Industries product (the "Product") that, for a period of one (1) year from date of shipment, the Product will be free from defects in material and workmanship under normal use and service, and provided the Product is installed, operated and maintained in accordance with instructions supplied by PS Industries. The terms and limitations of this Limited Warranty apply to all repaired or replacement Products for a term equal to the balance of the warranty remaining on the Product that was repaired or replaced as of the date of such repair or replacement. Register online at: www.psindustries.com/contact/register-your-product

PS Flood Barriers™ Product Warranty Registration: For PS Flood Barriers™ Products, this Limited Warranty will only be valid if the Owner completes the Warranty Registration Form provided within thirty (30) days of Product installation. To request a copy of the Warranty Registration Form, contact PS Industries Incorporated, 1150 S. 48th Street, Grand Forks, ND 58201, phone 877-446-1519, email: 4psinfo@psindustries.com. Register online at: www.psindustries.com/contact/register-your-product/ Additional Warranty Registration Forms can be downloaded at www.psfloodbarriers.com/download-center/

Warranty Exclusions: Notwithstanding anything to the contrary, this Limited Warranty does not cover any of the following:

1. Normal wear and tear (including, but not limited to, normal wear and tear to gaskets and weather seals); damage or accidents resulting from freight damage, from failure to follow precautionary safety measures, or applied paint failure; abuse, misuse or unauthorized modification of the Product; misapplication; improper installation; or any defects, damage or other harm that is not the result of the acts or omissions of PS Industries.
2. Cost of field labor or other charges incurred by Owner in removing and/or re-affixing the Product or any part or component thereof.
3. Transportation costs.

Unauthorized modification of or to the Product voids this Limited Warranty. Authorized modifications, received in writing from PS Industries, as long as the modification is accomplished in strict accordance with PS Industries' instructions, does not void warranty. To request product modifications contact PS Industries, 1150 S. 48th Street, Grand Forks, ND 58201, phone 877-446-1519, email: 4psinfo@psindustries.com.

Claim Procedure: To make a claim under this Limited Warranty, the claim must be received by PS Industries before the expiration of the above stated Limited Warranty period together with proof of purchase. Contact PS Industries at the address shown below.

| | |
|----------------------------|--|
| PS Industries Incorporated | Toll Free: 877-446-1519 |
| Attention: Warranty | Phone: 701-746-4519 |
| 1150 S. 48th Street | Fax: 701-746-8340 |
| Grand Forks, ND 58201 | E-mail: 4psinfo@psindustries.com |

An authorized PS Industries representative must be given a reasonable opportunity to inspect and investigate the alleged Product defect prior to any work being done that affects the Product or its installation. PS Industries reserves the right to charge reasonable amounts for travel and labor associated with investigation of claims. PS Industries may also require photographs of the alleged Product defect or return of the Product or part to a designated PS Industries location, freight prepaid. A return goods authorization must be received prior to the return of the Product or part. Please contact PS Industries to determine the designated location for return and to obtain the return material authorization.

Exclusive Remedy: In the event of a warranty claim that PS Industries determines to be covered by this Limited Warranty, PS Industries will replace or repair, at PS Industries' discretion, the Product or any part of the Product found to be defective.

Disclaimers: The above warranty and remedy is the sole express warranty and remedy given by PS Industries on its Product. No warranties or representations at any time made by any representative from PS Industries shall vary or expand the provisions hereof. TO THE EXTENT PERMITTED BY LAW, ALL EXPRESS AND IMPLIED WARRANTIES (INCLUDING IMPLIED WARRANTIES OF MERCHANTABILITY, FITNESS FOR A PARTICULAR PURPOSE AND NON-INFRINGEMENT) OTHER THAN THE EXPRESS LIMITED WARRANTY SET FORTH ABOVE ARE EXPRESSLY DISCLAIMED. UPON THE EXPIRATION OF THE ABOVE STATED LIMITED WARRANTY PERIOD, ANY AND ALL APPLICABLE IMPLIED WARRANTIES, INCLUDING, WITHOUT LIMITATION, WARRANTIES OF MERCHANTABILITY, FITNESS FOR A PARTICULAR PURPOSE AND NON-INFRINGEMENT, ARE DISCLAIMED. SOME STATES DO NOT ALLOW LIMITATION ON HOW LONG AN IMPLIED WARRANTY LASTS, SO THE ABOVE LIMITATION MAY NOT APPLY TO OWNER.

LIABILITY LIMITATION: In no event will PS Industries' liability to Owner or any other person or entity exceed the price paid to PS Industries for the defective Product. IN NO EVENT SHALL PS INDUSTRIES BE LIABLE TO OWNER OR ANY OTHER PERSON OR ENTITY FOR INCIDENTAL, CONSEQUENTIAL, INDIRECT OR SPECIAL DAMAGES OF ANY DESCRIPTION, WHETHER ARISING OUT OF WARRANTY (INCLUDING ANY IMPLIED WARRANTIES) OR ANY OTHER CONTRACT, STRICT LIABILITY, NEGLIGENCE OR OTHER TORT, OR OTHERWISE, INCLUDING ARISING FROM INSPECTION OR REMEDY DELAYS. SOME STATES DO NOT ALLOW THE EXCLUSION OR LIMITATION OF INCIDENTAL OR CONSEQUENTIAL DAMAGES, SO THE ABOVE LIMITATION AND EXCLUSION MAY NOT APPLY TO OWNER.

THIS WARRANTY GIVES OWNER SPECIFIC LEGAL RIGHTS AND OWNER MAY ALSO HAVE OTHER RIGHTS, WHICH VARY FROM STATE TO STATE.



877.446.1519

4psinfo@psindustries.com | psaccesssolutions.com

1150 South 48th Street | Grand Forks, ND 58201

Product Registration:

psindustries.com/contact/register-your-product