

HATCHGRIP®

Installation Instructions/Operation and Maintenance Manual

Models:

HTG-PCG

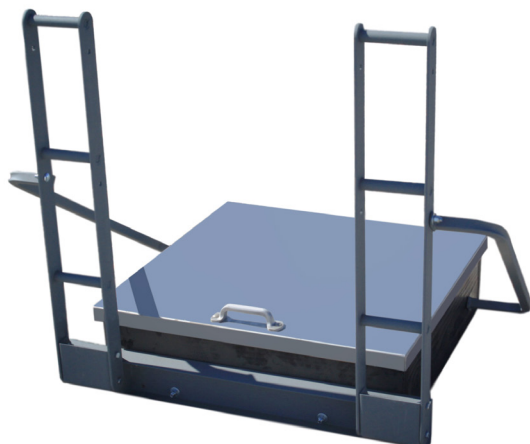

Table of Contents:

Safety Precautions 2
 Product Information 2
 Operation 3
 Installation Instructions 4
 Replacement Parts List 7
 Inspection and Maintenance..... 8
 Warranty Certificate 11

Contact Information

Mail PS Access Solutions 1150 South 48th Street Grand Forks, ND 58201	Local Phone 701.746.4519	Website psaccesssolutions.com	Hours of Operation 8 A.M. to 5 P.M. CT Monday – Friday
	Toll Free Phone 877.446.1519	Email 4psinfo@psindustries.com	

IMPORTANT! Read entire Instruction and Operations Manual to become familiar with the product.

NOTICE This product is a commercial product. The effectiveness of the product is directly related to the proper installation and operation of this product. Failure to properly maintain this product **will** affect performance.

Publication Notice

This manual has been compiled and published covering the latest product descriptions and specifications.

The contents of this manual and the specifications of this product are subject to change without notice.

PS Access Solutions reserves the right to make changes without notice in the specifications and materials contained herein and shall not be responsible for any damages (including consequential) caused by reliance on the materials presented, including but not limited to typographical and other errors relating to the publication.

PS Access Solutions and/or its respective suppliers may make improvements and/or changes in the product(s)/ service(s) offered and/or the program(s) at any time without notice.

Retain this manual for future reference.
 If you would like to download a copy of this manual, please go to
psaccesssolutions.com

Safety Precautions

The following icons are used throughout this Manual.

- ▲ DANGER** Indicates an imminently hazardous situation which, if not avoided, will result in death or serious injury.
- ▲ WARNING** Indicates a potentially hazardous situation which, if not avoided, could result in death or serious injury.
- ▲ CAUTION** Indicates a potentially hazardous situation which, if not avoided, may result in minor or moderated injury.
- NOTICE** Indicates manufacturer's statement of additional information.
- IMPORTANT!** Indicates a required action.
- CRITICAL** Indicates a vital component to product performance.

HatchGrip® Product Information

NOTICE Unauthorized modification of or to the Product voids this Limited Warranty. Authorized modifications, received in writing from PS INDUSTRIES INCORPORATED, as long as the modification is accomplished in strict accordance with PS INDUSTRIES INCORPORATED's instructions, does not void warranty. To request product modifications contact PS INDUSTRIES INCORPORATED, 1150 S. 48th Street, Grand Forks, ND 58201, phone 877-446-1519, email: 4psinfo@psindustries.com

I. General Information

- A. This manual contains information regarding installation, operation, and maintenance of the PS Access Solutions' HatchGrip®.
- B. PS Access Solutions recommends that the owner implement a regular maintenance program to inspect the HatchGrip® as necessary.
- C. Operation in a manner other than intended could result in damage or less than acceptable performance at time of need, for which the manufacturer will not be held responsible.

II. Storage Prior to Installation of Product

- A. Store materials in a dry, ventilated location. If outdoor storage is required, block materials and tarp in a tent-like arrangement, elevated above the product with open sides to allow airflow.

III. Installation Site Preparation

NOTICE Before starting site preparation and installation of the HatchGrip®, read the entire Operation and Maintenance Manual and review all installation instructions thoroughly.

- A. Clear work area of any debris.
- B. Ensure you have the necessary tools available.

▲ WARNING Ensure mounting surface is capable of supporting HatchGrip® (by others).

IV. Safety Precautions

- A. Ensure opening is clear of all obstructions.
- B. Comply with all OSHA and ANSI Safety Regulations and/or company safety policies when installing.
- C. Personnel: Determine the appropriate number of personnel required to perform installation and have them readily available at the project site. (1-2 people recommended)

▲ DANGER Ensure area below installation is blocked off from personnel during installation, and mounting surface is capable of supporting all loading. Structural analysis of mounting surface is the responsibility of the owner.

HatchGrip® Product Information

NOTE: Inventory carton to ensure all parts are present for assembly/installation. Refer to part list below.

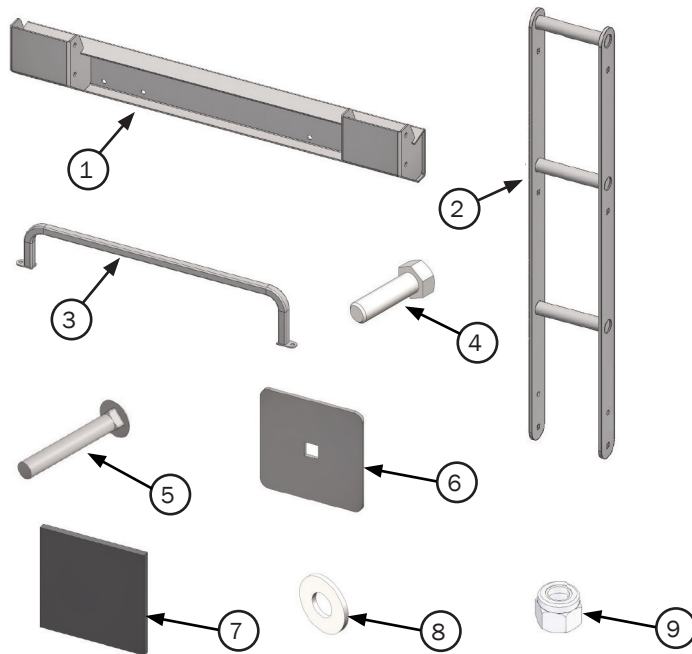

Recommended Tools:

1. One (2) $\frac{9}{16}$ " Wrenches
2. One (1) Electric Drill
3. One (1) $\frac{7}{16}$ " Drill Bit
4. One (1) Tape Measure
5. One (1) Level

HatchGrip® Part List (As shipped)

ITEM NUMBER	DESCRIPTION	QUANTITY
1	HTG;ASSY CURB BRKT	1
2	HTG;ASSY RUNG	2
3	HTG;ASSY SUPP TUBE	2
4	BOLT;HEX $\frac{3}{8}$ "16X1 $\frac{1}{4}$	10
5	BOLT;CARRIAGE $\frac{3}{8}$ "16X2- $\frac{1}{2}$	4
6	HTG;CRUSH PLATE	4
7	WS;CURB/CRUSH PLT WEATHER SEAL	4
8	WASHER;FLAT $\frac{3}{8}$ "	14
9	NUT;NYLOCK $\frac{3}{8}$ "16	14

V. Operation

A. When ascending the ladder:

1. When you have reached the hatch opening, use ladder rung continuation grips on the HatchGrip® to continue ascending the ladder. When entire body is outside of the hatch opening, exit the hatch opening. If hatch is unguarded, ensure hatch lid is closed.

B. When descending the ladder:

1. As you are about to enter the hatch opening, use ladder rung continuation grips on the HatchGrip® to stabilize yourself and begin to descending the ladder until you reach the floor/ground below you.

HatchGrip® Installation

VI. HatchGrip® Installation

STEP 1. Installing the Curb Bracket to the Hatch Curb Front

- a. Determine the mounting height of the Curb Bracket

IMPORTANT! Bottom rung must be higher than the top of the Hatch. (See Illustration A)

- b. Once height and center have been determined, mark the two holes that will be used while fastening to the existing curb. (See Illustration A)

IMPORTANT! It is recommended to select the mounting holes closest to the corners of the hatch assembly (Recommended holes are shown.)

- c. Square crush plate must be mounted to the interior of the hatch so you will have to allow for clearance. (See Illustration B)

IMPORTANT! Step 1:c MUST be done before fastening curb assembly to existing curb and allow for clearance.

- d. When holes are marked and you have ensured crush plate will fit, match drill holes with the $7/16$ " Drill Bit to ensure proper alignment.
- e. Before final fastening of the curb bracket, make sure the provided adhesive backed EPDM seal is at each anchor point (between the curb bracket and existing curb).
- f. Fasten front curb assembly to existing hatch curb using $3/8$ " x $2 1/2$ " carriage bolt, $3/8$ " washer, and $3/8$ " nylock nut.

**Step 1
Illustration A**

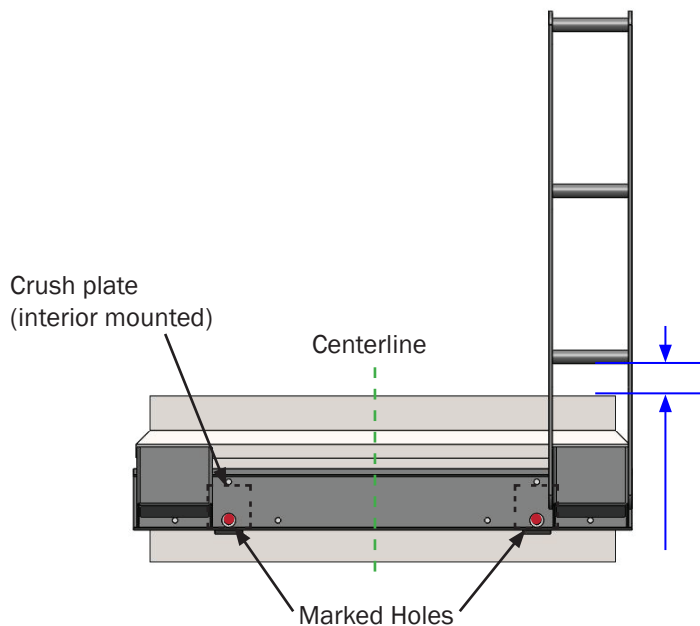

**Step 1
Illustration B**

IMPORTANT! Place the neoprene square seals between the curb bracket and existing curb.

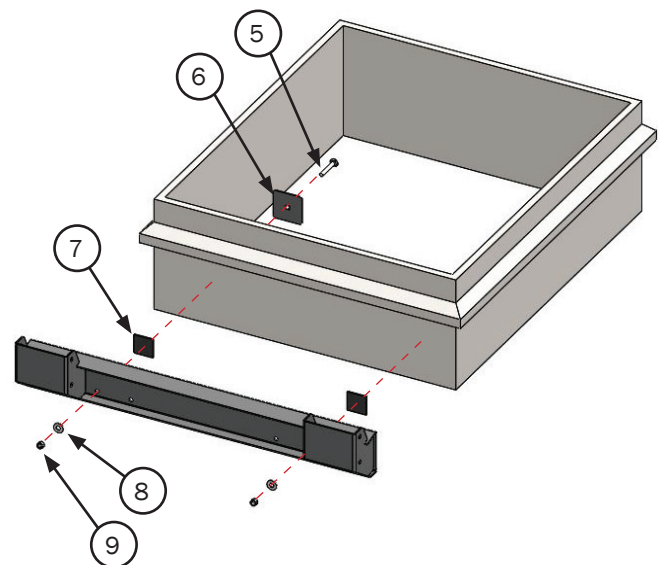

IMPORTANT! Make sure rung is above hatch cap flashing.

HatchGrip® Installation

STEP 2. Attaching Vertical Rung Assemblies.

- a. Fasten the vertical rung assemblies to the curb bracket with the provided $\frac{3}{8}$ " x $1\frac{1}{4}$ " hex bolts.

Step 2 Illustration

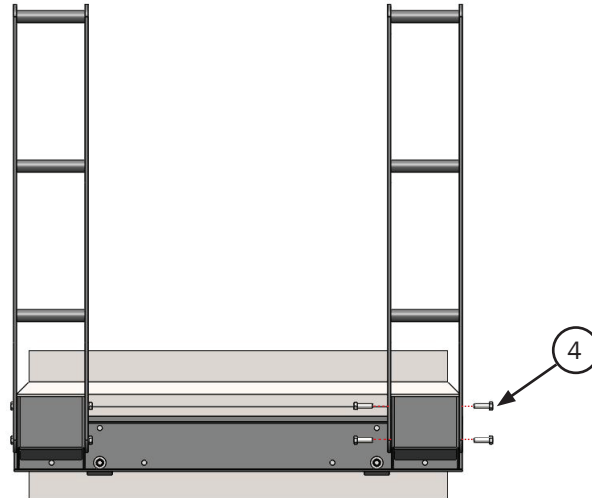

STEP 3. Determining the Support Tube Configuration (See Illustration A and Illustration B).

- a. Determine which support tube leg configuration fits your hatch.
 - * The length of both legs of the support tube are different lengths. This is to accommodate various roof hatch sizes.
- b. Rotate the support tube if required.

Step 3 Illustration A

Step 3 Illustration B

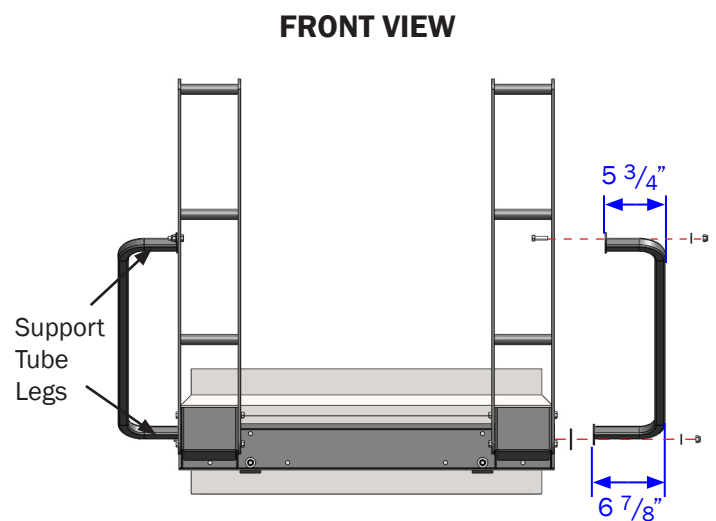
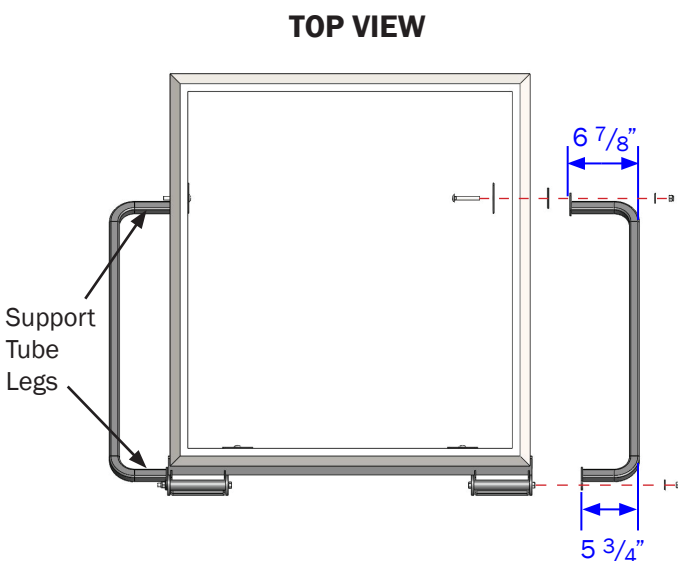

HatchGrip® Installation

STEP 4. Attaching Support Tubes

- Fasten the support tube to the existing hole in the vertical run assembly with the provided $\frac{3}{8}$ " x $1\frac{1}{4}$ " hex bolts.
- Position the opposite end of the support tube as far back from the rung assembly as possible. (See Illustration).
- Apply adhesive backed EPDM seal to the back side of the support tab.
- Fasten support tube through the hatch curb and crush plate (interior) using $\frac{3}{8}$ " x $2\frac{1}{2}$ " carriage bolt, $\frac{3}{8}$ " washer, and $\frac{3}{8}$ " nylock nut.
- Mark and drill using the provided $\frac{7}{16}$ " drill bit.
 - *Shimming the support tube rail out (by others, not PS Access Solutions) may be required depending on hatch design.

CRITICAL VERIFY INSTALLATION

- Ensure all bolts/nuts are tight.
- Ensure rigid installation.

Step 4 Illustration

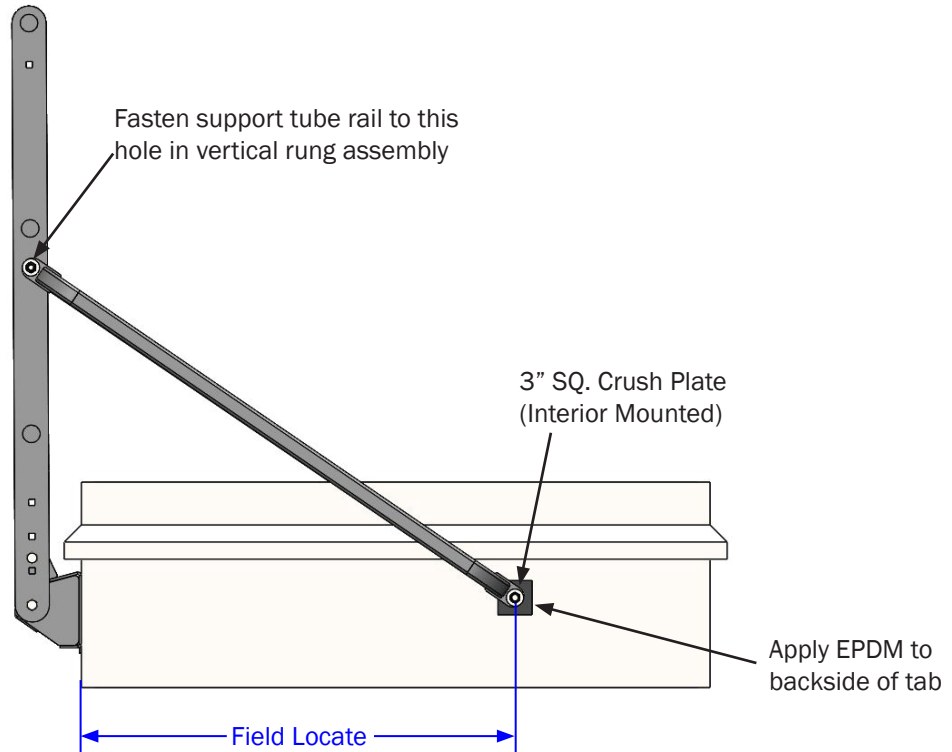

Replacement Parts List

XIII. Replacement Parts List

NOTE 1. Access Hatch is shipped fully assembled. Diagram is for part identification only.

NOTE 2. This diagram is for all Access Hatch MS/SS Models.

FINISH OPTIONS	
PCG	Powder Coat Gray

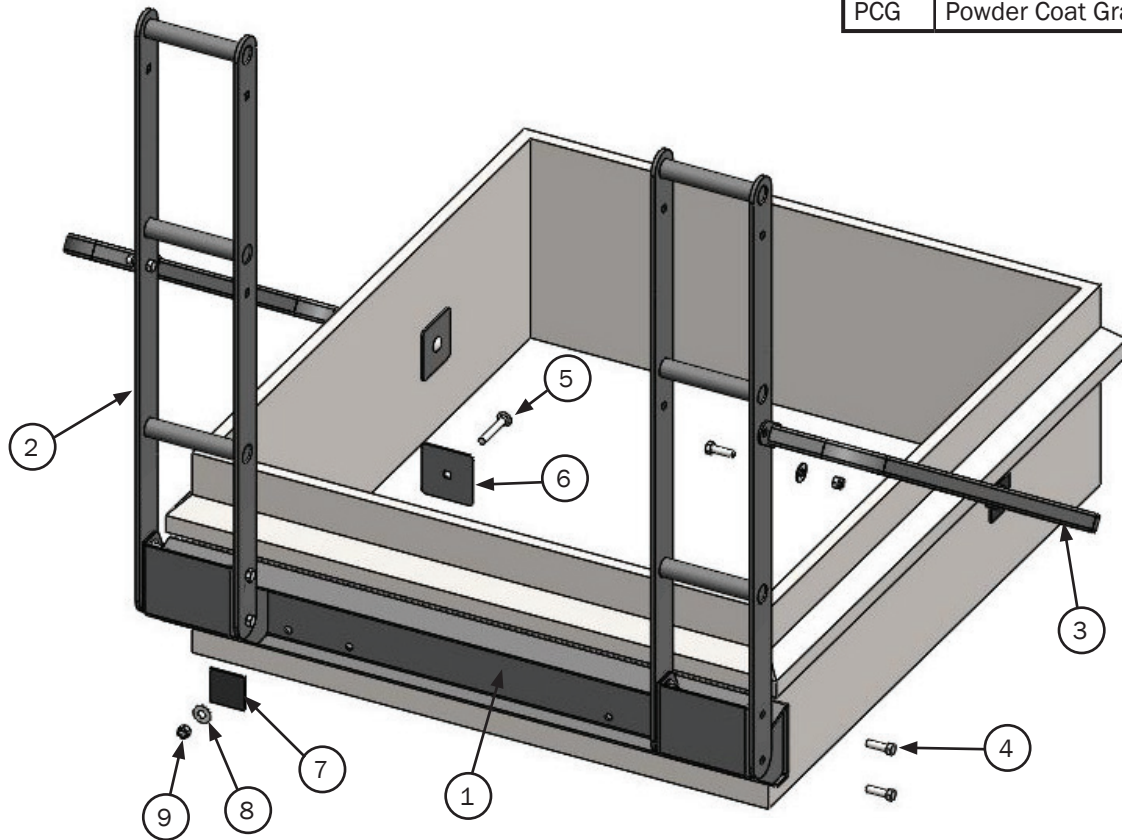

HatchGrip® Replacement Parts List			
ITEM #	DESCRIPTION	QTY	PART #
1	HTG;ASSY CURB BRKT-PCG	1	500801
2	HTG;ASSY RUNG-PCG	2	500802
3	HTG;ASSY SUPP TUBE PCG	2	500803
4	BOLT;HEX3/8"16X1 1/4GR8ZN	10	513992
5	BOLT;CARRIAGE3/8"16X2-1/2GR5ZN	4	500320
6	HTG;CRUSH PLATE-PCG	4	500807
7	WS;CURB/CRUSH PLT WEATHER SEAL	4	511040
8	WASHER;FLAT 3/8"ZN	14	501947
9	NUT;NYLOCK 3/8"16 ZN	14	501120

*Hardware on Stainless Steel Hatches to be 304 Alloy.

**TO ORDER PARTS CONTACT PS ACCESS SOLUTIONS AT
877.446.1519 or 4psinfo@psindustries.com**

Inspection and Maintenance

VIII. Inspection and Maintenance (Minimum Annually)

IMPORTANT! Consult parts list before replacing fasteners, as all have specific design load requirements. Only use like items for replacement.

A. HatchGrip®:

1. Inspect components for damage and misalignment. Adjust, repair, or replace as needed, to meet original design tolerance.
2. Check components for proper alignment. Adjust as necessary to achieve proper alignment.

B. Fasteners and mechanical connections

1. All fasteners must be in place and adjusted to their original design standard. Replace any damaged components.
2. Check all mounting connections, making sure they meet original design standards (refer to instructions).

C. Finishes

1. Inspect and clean finishes periodically.
2. Touch up repair finishes, or refinish as necessary to protect the structural integrity of the HatchGrip®.
3. The HatchGrip® comes with a polyester powder coat finish. Use finish materials compatible with powder coat. Follow paint manufacturers' instructions for prep and touch-up.

D. Housekeeping

1. To ensure your product continues to operate and last, upon completion of proper installation, complete the following:
 - a. Clean all surfaces.
 - b. If project is ongoing, protect installed products until final completion of project.
 - c. Touch-up, repair, or replace damaged components.

E. Labels and Placards:

1. Inspect all labels and placards.
2. Replace any labels and placards which are unreadable/missing.

Inspection and Maintenance Log

CRITICAL Periodic Inspection and Maintenance Required. Inspect at minimum annually.

Date Purchased: _____

Product: _____

Model Number: _____

Serial Number: _____

Opening Identifier/ Number: _____

Location: _____

DATE INSPECTED	INSPECTED BY <i>(Print & Sign)</i>	INSPECTION ITEMS NOTED	CORRECTIVE ACTION	CORRECTED BY <i>(Print & Sign)</i>

Inspection and Maintenance Log

CRITICAL Periodic Inspection and Maintenance Required. Inspect at minimum annually.

Date Purchased: _____

Product: _____

Model Number: _____

Serial Number: _____

Opening Identifier/ Number: _____

Location: _____

DATE INSPECTED	INSPECTED BY <i>(Print & Sign)</i>	INSPECTION ITEMS NOTED	CORRECTIVE ACTION	CORRECTED BY <i>(Print & Sign)</i>

PS INDUSTRIES INCORPORATED – LIMITED WARRANTY

Limited Warranty: Subject to the terms of this Limited Warranty, PS INDUSTRIES INCORPORATED warrants to the original user or consumer (the "Owner") of a PS INDUSTRIES INCORPORATED product (the "Product") that, for a period of one (1) year from date of shipment, the Product will be free from defects in material and workmanship under normal use and service, and provided the Product is installed, operated and maintained in accordance with instructions supplied by PS INDUSTRIES INCORPORATED. The terms and limitations of this Limited Warranty apply to all repaired or replacement Products for a term equal to the balance of the warranty remaining on the Product that was repaired or replaced as of the date of such repair or replacement.

PS Flood Barriers™ Product Warranty Registration: For PS Flood Barriers™ Products, this Limited Warranty will only be valid if the Owner completes the Warranty Registration Form provided within thirty (30) days of Product installation. To request a copy of the Warranty Registration Form, contact PS INDUSTRIES INCORPORATED, 1150 S. 48th Street, Grand Forks, ND 58201, phone 877-446-1519, email: 4psinfo@psindustries.com. Additional Warranty Registration Forms can be downloaded at www.psfloodbarriers.com/download-center/

Warranty Exclusions: Notwithstanding anything to the contrary, this Limited Warranty does not cover any of the following:

1. Normal wear and tear (including, but not limited to, normal wear and tear to gaskets and weather seals); damage or accidents resulting from freight damage, from failure to follow precautionary safety measures, or applied paint failure; abuse, misuse or unauthorized modification of the Product; misapplication; improper installation; or any defects, damage or other harm that is not the result of the acts or omissions of PS INDUSTRIES INCORPORATED.
2. Cost of field labor or other charges incurred by Owner in removing and/or re-affixing the Product or any part or component thereof.
3. Transportation costs.

Unauthorized modification of or to the Product voids this Limited Warranty. Authorized modifications, received in writing from PS INDUSTRIES INCORPORATED, as long as the modification is accomplished in strict accordance with PS INDUSTRIES INCORPORATED's instructions, does not void warranty. To request product modifications contact PS INDUSTRIES INCORPORATED, 1150 S. 48th Street, Grand Forks, ND 58201, phone 877-446-1519, email: 4psinfo@psindustries.com.

Claim Procedure: To make a claim under this Limited Warranty, the claim must be received by PS INDUSTRIES INCORPORATED before the expiration of the above stated Limited Warranty period together with proof of purchase. Contact PS INDUSTRIES INCORPORATED at the address shown below.

PS INDUSTRIES INCORPORATED	Toll Free: 877-446-1519
Attention: Warranty	Phone: 701-746-4519
1150 S. 48th Street	Fax: 701-746-8340
Grand Forks, ND 58201	E-mail: 4psinfo@psindustries.com

An authorized PS INDUSTRIES INCORPORATED representative must be given a reasonable opportunity to inspect and investigate the alleged Product defect prior to any work being done that affects the Product or its installation. PS INDUSTRIES INCORPORATED reserves the right to charge reasonable amounts for travel and labor associated with investigation of claims. PS INDUSTRIES INCORPORATED may also require photographs of the alleged Product defect or return of the Product or part to a designated PS INDUSTRIES INCORPORATED location, freight prepaid. A return goods authorization must be received prior to the return of the Product or part. Please contact PS INDUSTRIES INCORPORATED to determine the designated location for return and to obtain the return material authorization.

Exclusive Remedy: In the event of a warranty claim that PS INDUSTRIES INCORPORATED determines to be covered by this Limited Warranty, PS INDUSTRIES INCORPORATED will replace or repair, at PS INDUSTRIES INCORPORATED's discretion, the Product or any part of the Product found to be defective.

Disclaimers: The above warranty and remedy is the sole express warranty and remedy given by PS INDUSTRIES INCORPORATED on its Product. No warranties or representations at any time made by any representative from PS INDUSTRIES INCORPORATED shall vary or expand the provisions hereof. TO THE EXTENT PERMITTED BY LAW, ALL EXPRESS AND IMPLIED WARRANTIES (INCLUDING IMPLIED WARRANTIES OF MERCHANTABILITY, FITNESS FOR A PARTICULAR PURPOSE AND NON-INFRINGEMENT) OTHER THAN THE EXPRESS LIMITED WARRANTY SET FORTH ABOVE ARE EXPRESSLY DISCLAIMED. UPON THE EXPIRATION OF THE ABOVE STATED LIMITED WARRANTY PERIOD, ANY AND ALL APPLICABLE IMPLIED WARRANTIES, INCLUDING, WITHOUT LIMITATION, WARRANTIES OF MERCHANTABILITY, FITNESS FOR A PARTICULAR PURPOSE AND NON-INFRINGEMENT, ARE DISCLAIMED. SOME STATES DO NOT ALLOW LIMITATION ON HOW LONG AN IMPLIED WARRANTY LASTS, SO THE ABOVE LIMITATION MAY NOT APPLY TO OWNER.

LIABILITY LIMITATION: In no event will PS INDUSTRIES INCORPORATED's liability to Owner or any other person or entity exceed the price paid to PS INDUSTRIES INCORPORATED for the defective Product. IN NO EVENT SHALL PS INDUSTRIES INCORPORATED BE LIABLE TO OWNER OR ANY OTHER PERSON OR ENTITY FOR INCIDENTAL, CONSEQUENTIAL, INDIRECT OR SPECIAL DAMAGES OF ANY DESCRIPTION, WHETHER ARISING OUT OF WARRANTY (INCLUDING ANY IMPLIED WARRANTIES) OR ANY OTHER CONTRACT, STRICT LIABILITY, NEGLIGENCE OR OTHER TORT, OR OTHERWISE, INCLUDING ARISING FROM INSPECTION OR REMEDY DELAYS. SOME STATES DO NOT ALLOW THE EXCLUSION OR LIMITATION OF INCIDENTAL OR CONSEQUENTIAL DAMAGES, SO THE ABOVE LIMITATION AND EXCLUSION MAY NOT APPLY TO OWNER.

THIS WARRANTY GIVES OWNER SPECIFIC LEGAL RIGHTS AND OWNER MAY ALSO HAVE OTHER RIGHTS, WHICH VARY FROM STATE TO STATE.

Rev. 103018



877.446.1519

4psinfo@psindustries.com | psaccesssolutions.com

1150 South 48th Street | Grand Forks, ND 58201