

INDUSTRIAL SLIDING DOOR

Installation Instructions/Operation and Maintenance Manual

Models:

SLDB



Table of Contents:

Safety Precautions	2
Product Information	2
Installation Instructions	4
Replacement Parts List	14
Inspection and Maintenance.....	16
Warranty Certificate	19

Contact Information

Mail

PS Access Solutions
1150 South 48th Street
Grand Forks, ND 58201

Local Phone

701.746.4519

Website

psaccesssolutions.com

Hours of Operation

8 A.M. to 5 P.M. CT
Monday – Friday

Toll Free Phone

877.446.1519

Email

4psinfo@psindustries.com

IMPORTANT! Read entire Instruction and Operations Manual to become familiar with the product.

NOTICE This product is a commercial product. The effectiveness of the product is directly related to the proper installation and operation of this product. Failure to properly maintain this product **will** affect performance.

Publication Notice

This manual has been compiled and published covering the latest product descriptions and specifications.

The contents of this manual and the specifications of this product are subject to change without notice.

PS Access Solutions™ reserves the right to make changes without notice in the specifications and materials contained herein and shall not be responsible for any damages (including consequential) caused by reliance on the materials presented, including but not limited to typographical and other errors relating to the publication.

PS Access Solutions and/or its respective suppliers may make improvements and/or changes in the product(s)/ service(s) offered and/or the program(s) at any time without notice.

Retain this manual for future reference.

If you would like to download a copy of this manual, please go to psaccesssolutions.com

Product registration is an essential step to protecting your product, register Online at psindustries.com/contact/register-your-product/

Safety Precautions

The following icons are used throughout this Manual.

▲ DANGER Indicates an imminently hazardous situation which, if not avoided, will result in death or serious injury.

▲ WARNING Indicates a potentially hazardous situation which, if not avoided, could result in death or serious injury.

▲ CAUTION Indicates a potentially hazardous situation which, if not avoided, may result in minor or moderated injury.

NOTICE Indicates manufacturer's statement of additional information.

IMPORTANT! Indicates a required action.

CRITICAL Indicates a vital component to product performance.

Product Information

NOTICE Unauthorized modification of or to the Product voids this Limited Warranty. Authorized modifications, received in writing from PS Industries® Incorporated, as long as the modification is accomplished in strict accordance with PS Industries' instructions, does not void warranty. To request product modifications contact PS Industries, 1150 S. 48th Street, Grand Forks, ND 58201, phone 877-446-1519, email: 4psinfo@psindustries.com

I. General Information

- A. This manual contains information regarding installation, operation, and maintenance of the PS Access Solutions™ Industrial Sliding Doors.
- B. PS Access Solutions recommends that the owner implement a regular maintenance program to inspect the Industrial Sliding Door as necessary.

II. Operation Guidelines

- A. Operation in a manner other than intended could result in damage or less than acceptable performance at time of need, for which the manufacturer will not be held responsible.
- B. Protect all finishes, weatherseals, and hardware. Always consult original Approved for Construction drawings for all installation dimensions, details, hardware, and specifications.

III. Safety Precautions

- A. Ensure opening is clear of all obstructions or debris, through the entire travel of the door.
- B. Comply with all OSHA Safety Regulations and/or company safety policies when installing.
- C. Use the handles when contacting the door, staying clear of pinch points.
- D. Do not force panels or components if they do not operate freely.

▲ WARNING The Industrial Sliding Door components MAY BE heavy, consult Approved for Construction drawings and included documents for weights and use appropriate lifting procedures and equipment.

IV. Storage Prior to Installation of Product

- A. Store materials in a dry, ventilated location. If outdoor storage is required, block materials and tarp in a tent-like arrangement, elevated above the product with open sides to allow airflow.

V. Installation Site Preparation

NOTICE Before starting site preparation and installation of the Industrial Sliding Door, read the entire Operation and Maintenance Manual and review all installation instructions thoroughly.

- A. Clear work area of any debris.
- B. Ensure you have the necessary tools available.
- C. Obtained all required permits.
- D. Personnel: Determine the appropriate number of personnel required to perform installation and have them readily available at the project site.

▲ DANGER Ensure mounting surface is capable of supporting all loading. Structural analysis of mounting surface is the responsibility of the owner.

Product Information

VI. Operation

A. Under normal operation, the PS Access Solutions' Industrial Sliding Door operates by sliding horizontally along the top track system in both directions.

1. To operate, grasp the handle and slide in the direction away from the closed position.
2. Repeat operation in the opposite direction to close.

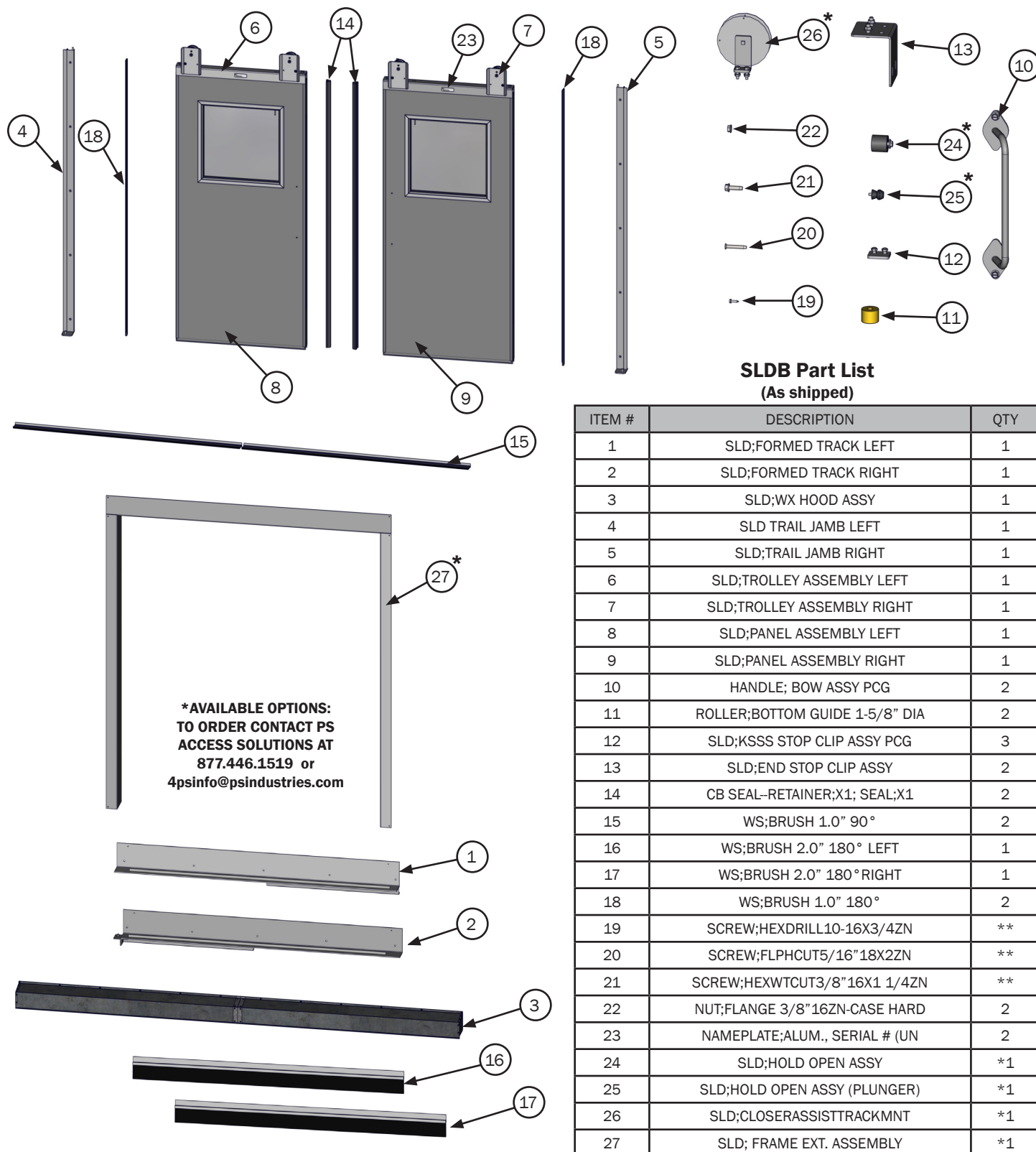

Installation

VII. Industrial Sliding Door Installation

NOTICE Only use Approved for Construction Drawings.

IMPORTANT! Any field modifications, if required, must be coordinated with PS Access Solutions.

STEP 1. Review all Approved for Construction drawings sent with the crated Industrial Sliding Door.
The Approved for Construction Drawings are located inside a plastic bag inside the crate. Review all installation labels prior to installation.

STEP 2. All components must be sound, flat/level, and without blemish for best performance as indicated on Approved for Construction Drawings.

*Permissible tolerance is $\pm \frac{1}{16}$ " per 10 foot length.

STEP 3. Determine levelness of slide path. The sliding path **MUST** be level.

a. If imperfections are present: locate the high point on the floor along the entire travel path of the door.
(Point #1)

b. Mark this point on the door jambs as shown by the dotted line. (Point #2)

*These marks will be used to locate the Stop Jamb Angle and Trail Jamb Channel in Step 6.

Step 3 Illustration

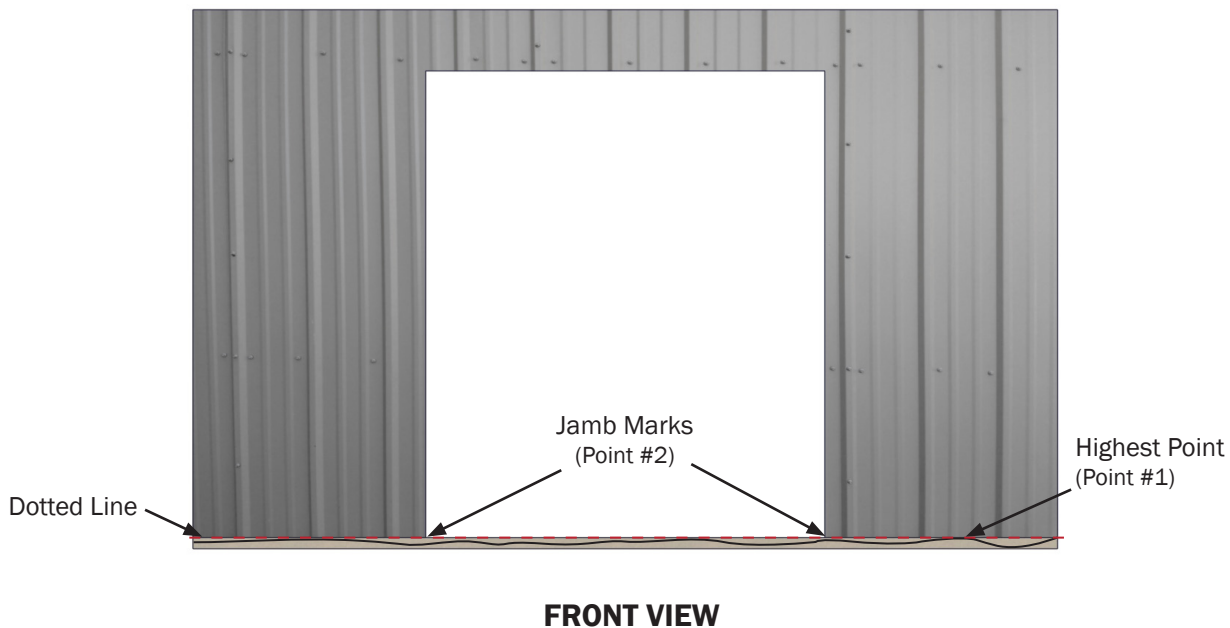

Installation

NOTICE Step 4 is for optional Frame Extension, as called out on Approved for Construction Drawings. If you do not have a Frame Extension skip to Step 5. If you require a Frame Extension, call PS Access Solutions at 877.446.1509 to order.

- STEP 4.** Dry fit the three (3) Frame Extension pieces in the opening. If all pieces fit properly:
- Lay Frame Extension on a flat/level surface and weld together, making sure assembly is square.
 - Once welded together, slip Frame Extension Assembly into opening and weld or mechanically fasten into place.

Step 4 Illustration

Optional:
Frame Extension



- STEP 5.** Determine Jamb Lap Distance.

Required edge distance specified in Approved for Construction Drawings.

- The Lap Distance is the distance from the edge of the opening to the outside of the Trail Jamb Channel.
- Mark this distance on the Jamb. (Point #3 & Point #4)

*This mark will be used to locate the Trail Jamb Channel in a Step 6.

Step 5 Illustration

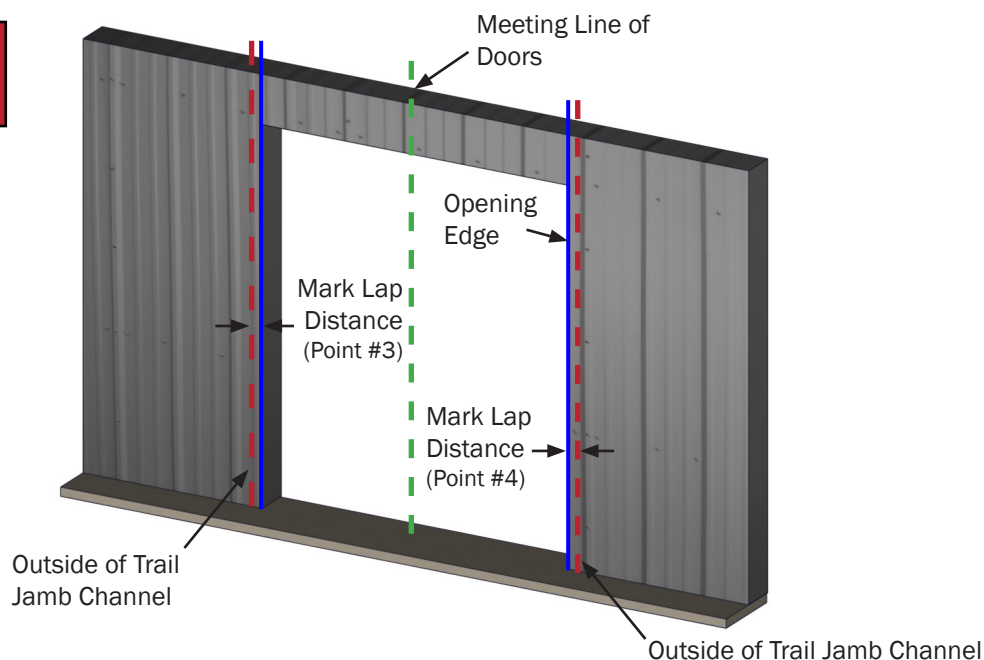

Installation

STEP 6. Mount the Trail Jamb Channel to the door jamb or wall.

- The outside edge of the Trail Jamb Channel should line up with the marks (Point #3, Point #4) from Step 5.
- Bottom of the attached stay roller plate should be **FLUSH** with the high point (Point #1) from Step 3.

*If the floor is reasonably level, this plate will rest on the floor. Permissible tolerance is $\pm \frac{1}{16}$ " per 10 foot length.

Step 6 Illustration

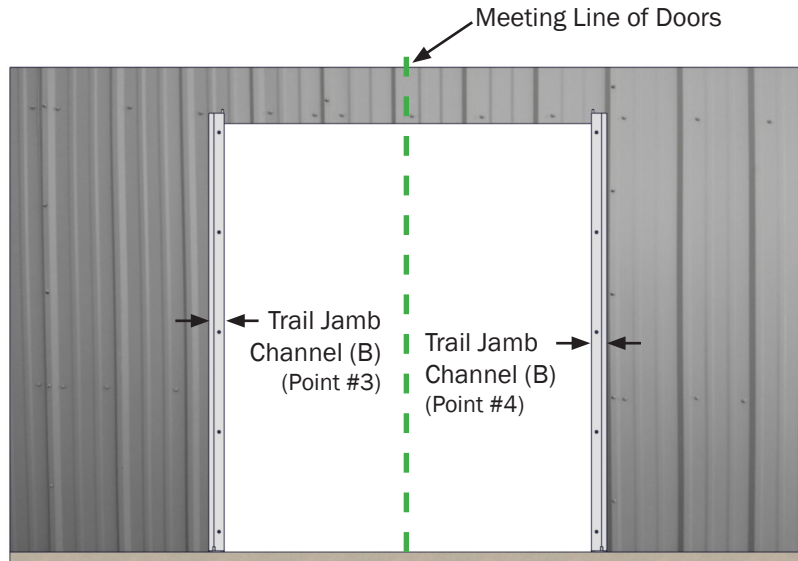

STEP 7. Mount Formed Track to the top of the Trail Jamb Channel.

- Place the Formed Track Assembly on the $\frac{3}{8}$ " threaded stud welded to the top of Trail Jamb Channel.
- To fasten the pieces together, tighten the provided $\frac{3}{8}$ " flange nut.
- After making sure the track is in the correct position and level, anchor track securely to building structure at holes provided.

* Provide additional bracing or block outs, as required, where no wall attachment is available.

Step 7 Illustration

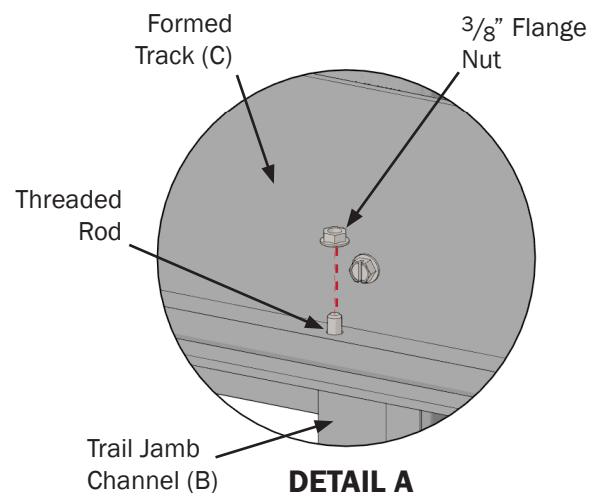

Installation

STEP 8. Install Bottom Guide Rollers on bottom stud of Trail Jamb Channels.

Step 8 Illustration

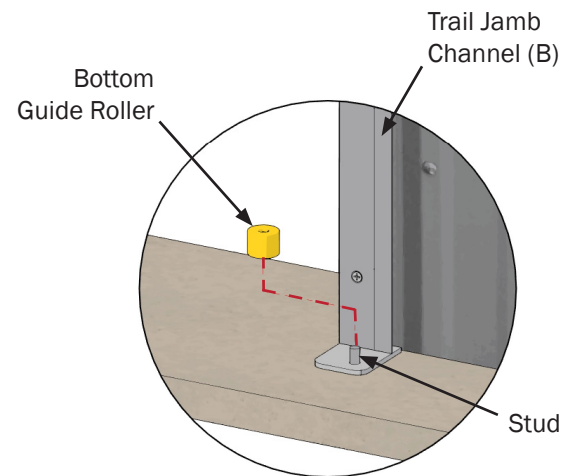

Installation

STEP 10. Installing Sliding Door Panel Assembly.

- Remove Safety Studs. (Refer to Illustration A)
 - Set door panel over the Bottom Guide Roller. (Refer to Illustration B)
 - Lift door slightly to set Top Rollers on the Track Rail.
 - Re-install Safety Studs, move door back and forth slowly to ensure proper operation.
 - Repeat Steps 10 a. through Steps 10 d for other door panel.
 - Align doors with each other and/or trail jambs by adjusting top trolley bolts, adjusting floor clearance with these bolts. (Refer to Illustration C)
- *Be sure to tighten the jamb nuts to lock adjustments in place.

**Step 10
Illustration A**

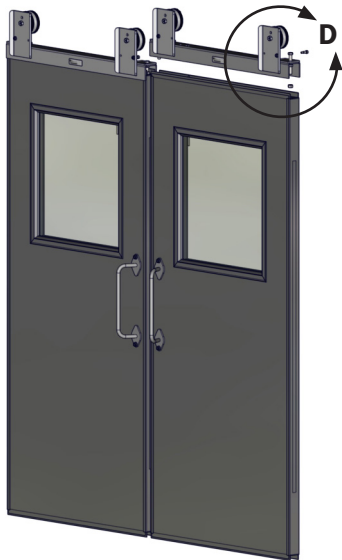

**Step 10
Illustration B**

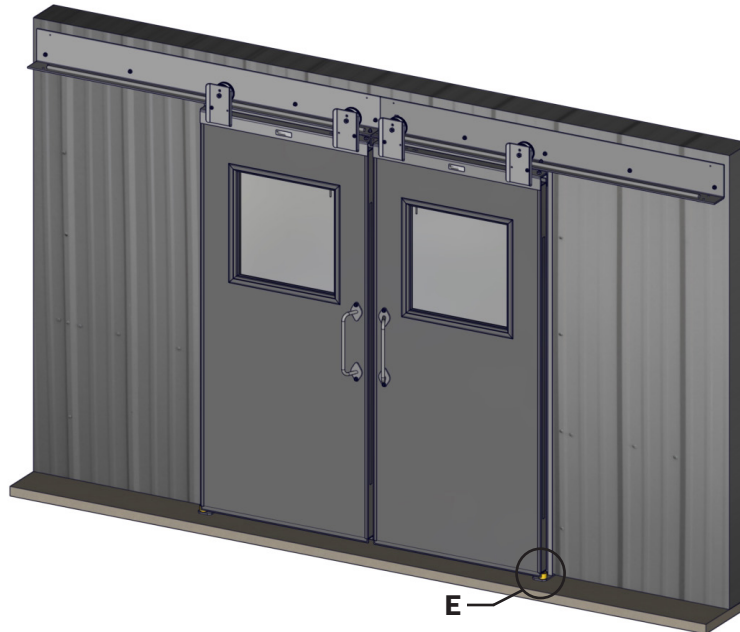

**Step 10
Illustration C**

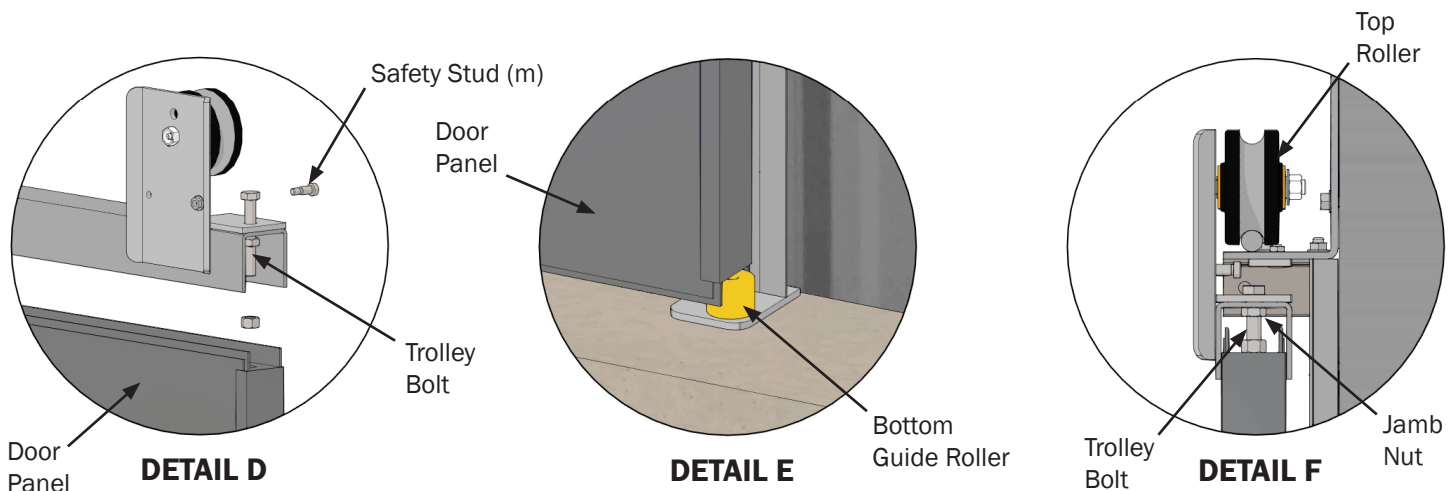
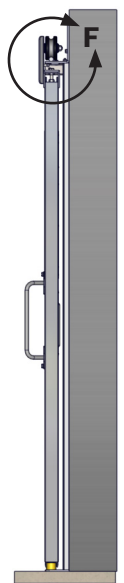

Installation

NOTICE Only use Approved for Construction Drawings.

STEP 11. Installing Weatherseals.

- Attach Head Seal to Head Channel. It should extend all the way to the Center Stop Angle and be flush with the bottom of the Head Channel. (Refer to Detail I)
- Attach Trail Jamb Seal to trailing edge of door, NOT to Trail Jamb. Refer to Approved for Construction Drawings for correct side. (Refer to Detail G)

CRITICAL Keep screws above bottom Door Guide Channel.

- Attach Sill Brush to the bottom of the door panel. Sill Brush should touch ground, be careful to not screw into the channel.
- Use weather-strip screws (AC) provided for all Brush Seals.

**Step 11
Illustration A**



**Step 11
Illustration B**

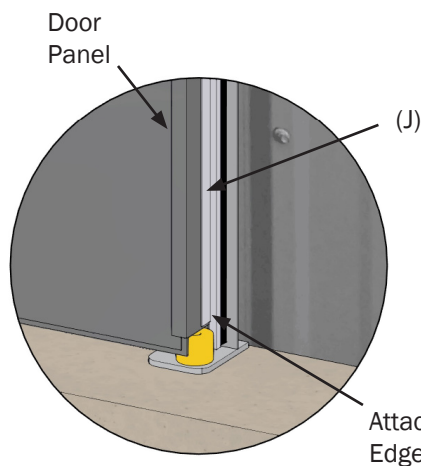
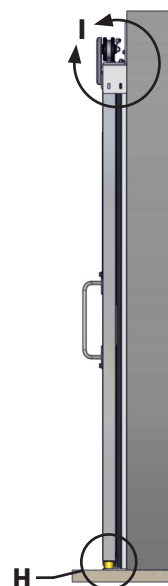

DETAIL G

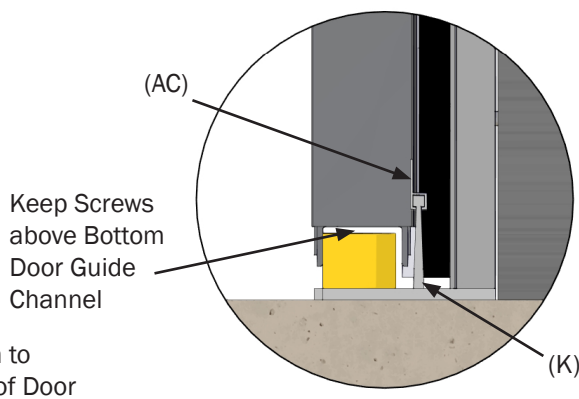

DETAIL H

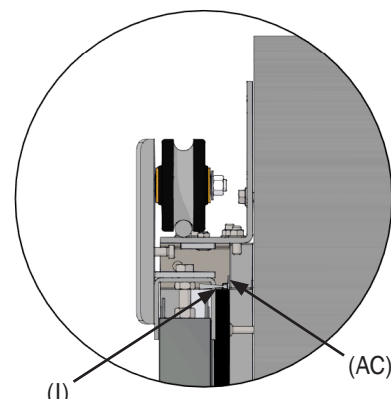

DETAIL I

Installation

NOTICE If the Center Bulb Seals are factory installed, skip Step 12.

STEP 12. Follow steps below, if Center Bulb Seal is NOT installed.

- a. Attach the aluminum retainer to the leading edge of the door panel using weather strip screws (AC), lining up inside web of top channel. (Refer to Detail J)
- b. Slide the “T” ends of rubber bulb seal into the outer tracks in the retainer. (Refer to Detail K)
 1. Gently pull the rubber bulb along the retainer, being careful to guide the rubber bulb at the starting end of the retainer to ensure it does not slip out of the tracks or bind up.
 2. Pull rubber bulb out past the end of the retainer about 6”. You can trim off any excess seal at the starting end, leaving about 6” of overhang.
- c. Tuck the ends of the bulb back into itself to secure the rubber bulb seal.

Step 12 Illustration

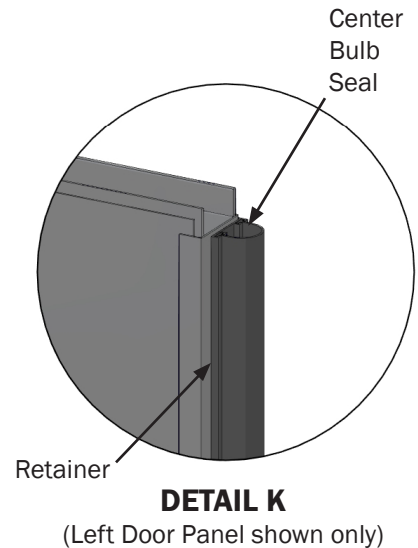
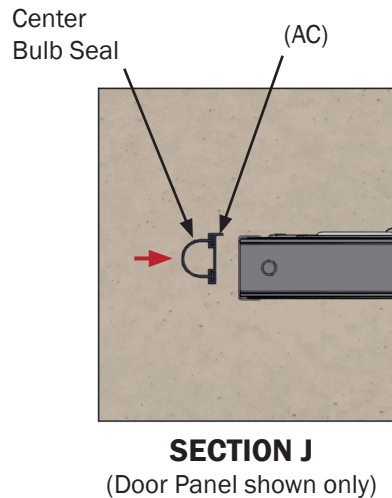
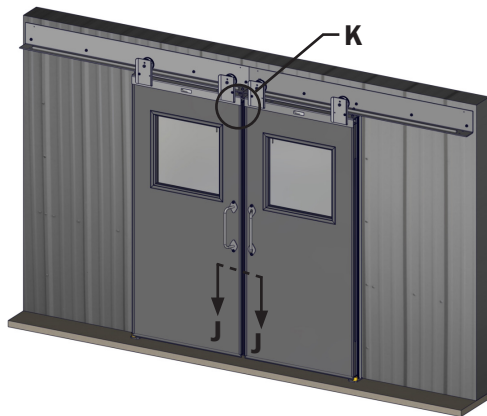

STEP 13. Installing End Caps in Weatherhood (Optional).

- a. Center Weatherhood above track.
 1. Using the end caps as a height guide, attach weatherhood to track flange using provided #14 x 1” self-drilling screws.
 - *The bottom flange of the hood end will sit underneath the track angle.
 2. Attach weatherhood to hood ends using #10 x 3/4” self-drilling screws.
 3. Fasten bottom of hood end to track using #14 x 1” self-drilling screws.
 4. If a weatherhood splice strip is provided, use splice strip to connect weatherhood sections together at seams.
 5. Flash or caulk as required (by others NOT PS Access Solutions).

Step 13 Illustration

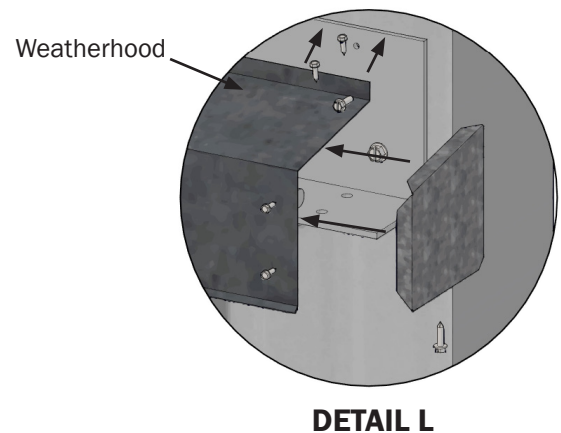

Installation

VIII. Closer Assist Track Mount Installation (Optional)

NOTICE Only use Approved for Construction Drawings.

IMPORTANT! Any field modifications, if required, must be coordinated with PS Access Solutions.

STEP 1. Review all Approved for Construction drawings sent with the crated Industrial Sliding Door. The Approved for Construction Drawings are located inside a plastic bag inside the crate. Review all installation labels prior to installation.

STEP 2. If factory located holes are not present, drill $\frac{5}{16}$ " holes through track in locations as shown. (Refer to Detail M)

Step 2 Illustration

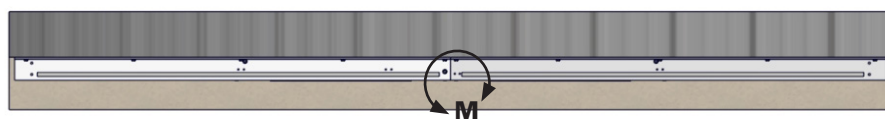

TOP VIEW

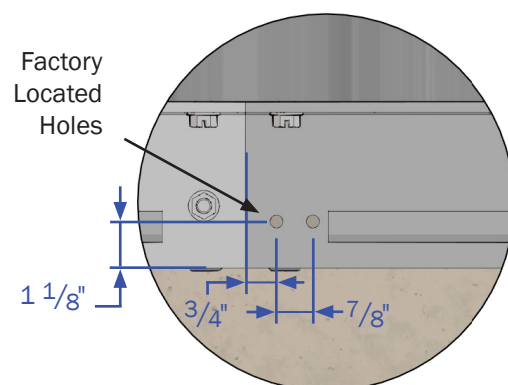

DETAIL M

STEP 3. Installing Closer Assist Reel Angle Assembly.
 a. Bolt angle to track with provided $\frac{1}{4}$ " Hex Bolts and $\frac{1}{4}$ " Flange Nuts.
 b. Replace washer on trolley axle and replace with axle hook plate.

Step 3 Illustration

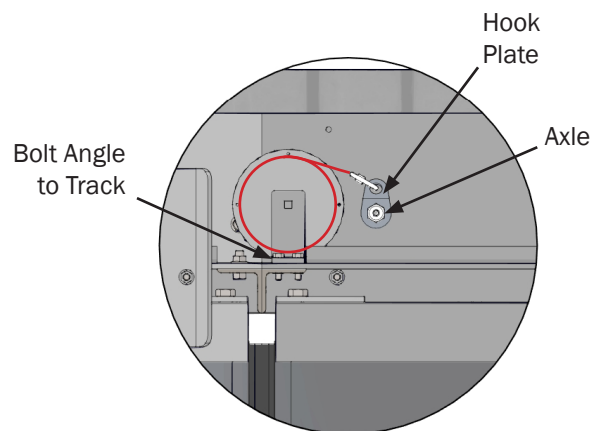

DETAIL N

Installation

NOTICE Spring reel closer can be pre wound for the desired pull force when door is in the closed position. DO NOT allow full cable extension in open position as early spring failure may occur.

STEP 4. Attach cable to hook plate using quick link.

**Step 4
Illustration A**

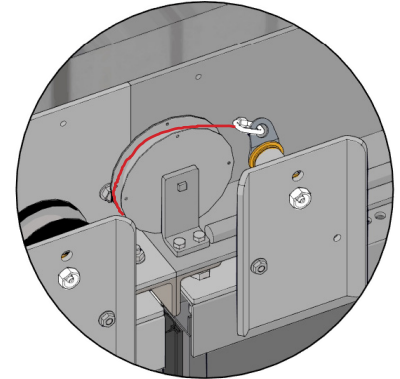

DETAIL O

**Step 4
Illustration B**

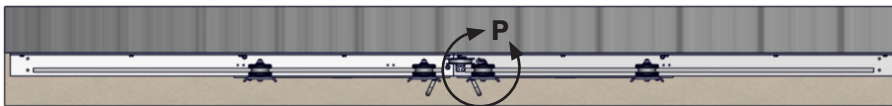

TOP VIEW

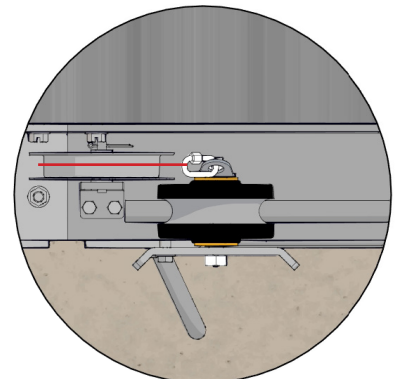

DETAIL P

Installation

IX. Hold-Open Installation (Optional)

NOTICE Only use Approved for Construction Drawings.

IMPORTANT! Any field modifications, if required, must be coordinated with PS Access Solutions.

STEP 1. Review all Approved for Construction drawings sent with the crated Industrial Sliding Door. The Approved for Construction Drawings are located inside a plastic bag inside the crate. Review all installation labels prior to installation.

STEP 2. Measure and mark $1\frac{3}{4}"$ from top of door panel to locate plunger in center of door edge.
 a. Drill DIA .201 and tap $\frac{1}{4}"$ - 20 hole.
 b. Secure plunger with provided $\frac{1}{4}"$ hex bolt.

Step 2 Illustration

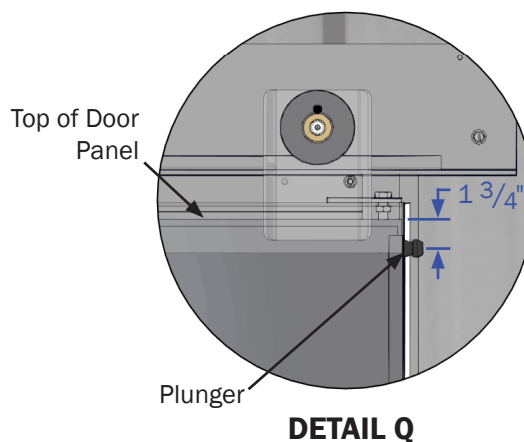
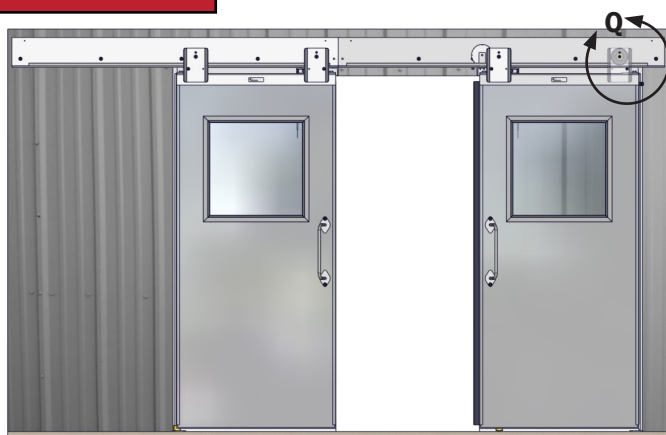

STEP 3. Replace standard stop clip with hold open angle.
 a. Insert $\frac{3}{8}"$ hex bolts into first set of holes in hold-open angle and secure $\frac{3}{8}"$ flange nuts.
 b. Adjust height of socket to line up with plunger.

Step 3 Illustration

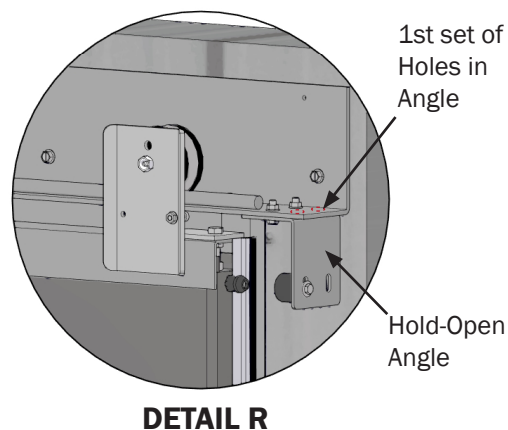

Replacement Parts List

X. Replacement Parts List

NOTE 1. Review all Approved for Construction drawings for specific part numbers.

NOTE 2. This replacement parts list is for Bi-Parting Industrial Sliding Door Models.

NOTE 3. Diagram and details are located on Page 15.

**TO ORDER PARTS CONTACT PS ACCESS SOLUTIONS AT
877.446.1519 or 4psinfo@psindustries.com**

*Additional options available for purchase.

**Refer to Approved for Construction Drawings for type.

Replacement Parts List			
ITEM #	DESCRIPTION	QTY	PART #
1	SLD;FORMED TRACK, LEFT	1	TRWLD-L-
2	SLD;FORMED TRACK, RIGHT	1	TRWLD-R-
3	SLD;WX HOOD ASSY	1	WX HOOD-
4	SLD;TRAIL JAMB LEFT	1	TRLJM-L-
5	SLD;TRAIL JAMB RIGHT	1	TRLJM-R-
6	SLD;TROLLEY ASSEMBLY LEFT	1	TRLY L-
6.1	ROLLER;TOP GUIDE 4"	2	501457
6.2	ROLLER;BEARING	2	501450
6.3	SPANNER DRILLED	2	501649
6.4	BEARING SEAL	4	500292
6.5	AXLE W/ GREASE FITTING NUT	2	500157-1
6.6	AXLE W/ GREASE FITTING NUT	2	500157-2
6.7	WASHER;FLAT 1/2"ZN USS	2	501937
7	SLD;TROLLEY ASSEMBLY RIGHT	1	TRLY R-
7.1	ROLLER;TOP GUIDE 4"	2	501457
7.2	ROLLER;BEARING	2	501450
7.3	SPANNER DRILLED	2	501649
7.4	BEARING SEAL	4	500292
7.5	AXLE W/ GREASE FITTING NUT	2	500157-1
7.6	AXLE W/ GREASE FITTING NUT	2	500157-2
7.7	WASHER;FLAT 1/2"ZN USS	2	501937
7.8	SLDS;CLOSERASSISTAXLEHOOKPLATE	1	507247
7.9	QUICK LINK, 1/8"	1	508109
8	SLD;PANEL ASSEMBLY LEFT	1	LDOOR ASM-
9	SLD;PANEL ASSEMBLY RIGHT	1	RDOOR ASM-
10	HANDLE; BOW ASSY PCG	2	510311
11	ROLLER;BOTTOM GUIDE 1-5/8" DIA	2	501453
12	SLD;KSSS STOPCLIP ASSY PCG 1/4	3	514391
12.1	SLD;KSSS STOP CLIP PCG	1	514390
12.2	NUT; JAM 5/16"18 ZN	2	501108
12.3	BOLT;TRACK5/16"18X3/4" ZN	2	500458

Replacement Parts List			
ITEM #	DESCRIPTION	QTY	PART #
13	SLD;END STOP CLIP ASSY 2" PCG	2	510287
13.1	SLD;STOP ANGLE 2" PCG	1	510288
13.2	BOLT;HEX3/8"16X1GR5ZN	2	500400
13.3	NUT;FLANGE 3/8"16ZN-CASE HARD	2	501085
14	CB SEAL-RETAINER;81"X1;SEAKL91X1	2	507237-
15	WS;BRUSH 1.0 180 DEG	2	501986-
16	WS;BRUSH 2.0 180 DEG	1	501995L-
17	WS;BRUSH 2.0 180 DEG	1	501995R-
18	WS;BRUSH 1.0 90 DEG	2	501990-
19	SCREW;HEXDRILL 10-16X3/4ZN	29	501497
20	SCREW;FLPHCUT5/16"18X2ZN	10	501465
21	SCREW;HEXWTCUT3/8"16X 1 1/4ZN	10	501489
22	NUT;FLANGE 3/8"16ZN-CASE HARD	2	501085
23	NAMEPLATE; ALUM., SERIAL #(UN	2	503057

Additional Options			
ITEM #	DESCRIPTION	QTY	PART #
24	SLD;HOLD OPEN ASSY	*1	501617-1
24.1	SLDS;DOOR HOLD OPEN	1	501635-1
24.2	WASHER;FLAT 5/16"ZN	1	501949
24.3	BOLT;HEX 5/16"-18X1" ZN	1	502704
25	SLD;HOLD OPEN ASSY (PLUNGER)	*1	501617-2
25.1	SLDS;DOOR HOLD OPEN	1	501635-2
25.2	BOLT;HEX1/420X1GR5ZN	1	500373
26	SLD;CLOSERASSISTTRACKMNT	*1	507248
26.1	SLD;SRC ANGLE-PCG	1	511188
26.2	SPRING REEL, METAL 5" DIA X .8"	1	501654
26.3	PIN;COTTER 3/32 X 1 1/4ZN	1	501250
26.4	BOLT;HEX1/4"20X1GR5ZN	2	500373
26.5	NUT;FLANGE 1/4"20ZN-CASE HARD	2	501084
27	SLD;FRAME EXT. ASSEMBLY	*1	F EXT-
28	LITE;ASSY MULTI CONFIGURATION	*	**

Replacement Parts List

XI. Replacement Parts Diagram

NOTE 1. This diagram is for Bi-Parting Industrial Sliding Door Models.

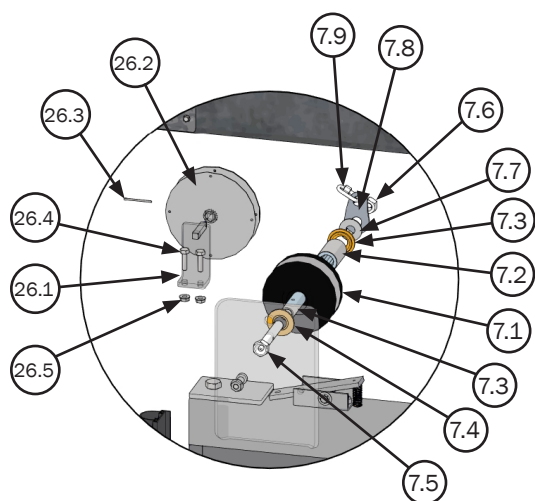
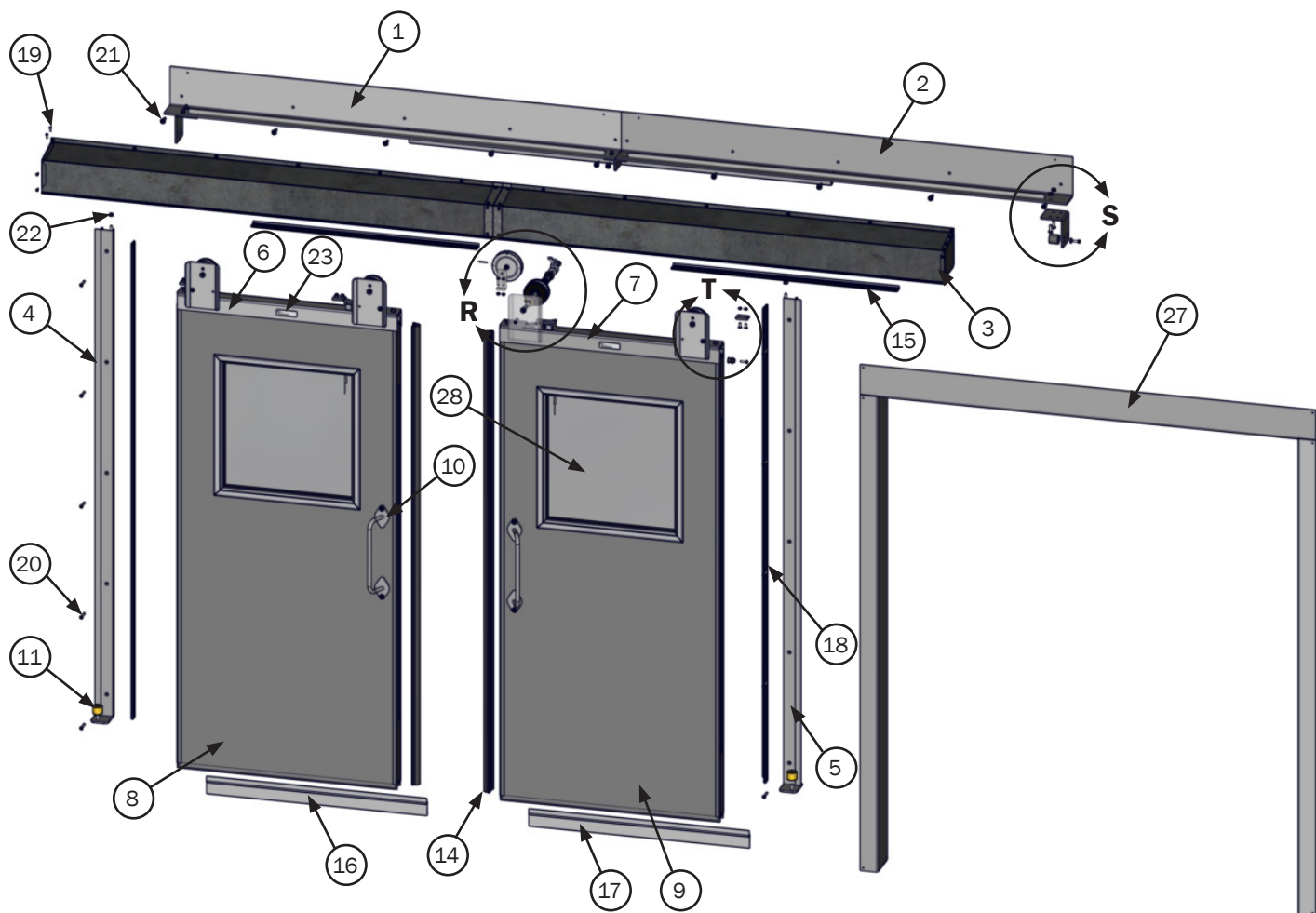

DETAIL R

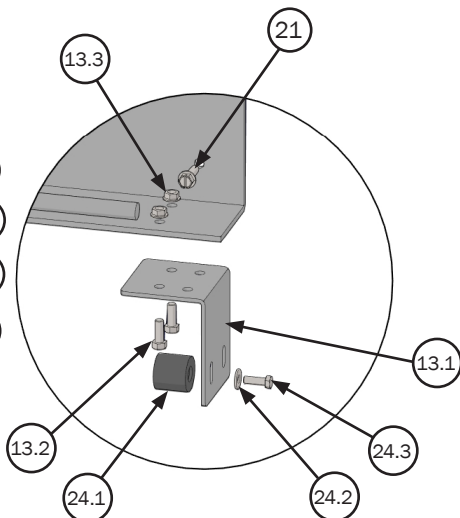

DETAIL S

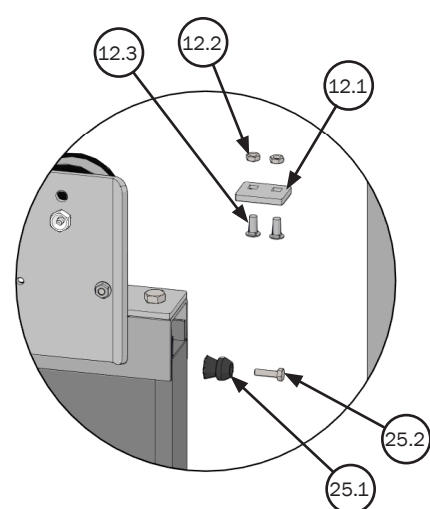

DETAIL T

Inspection and Maintenance

XII. Inspection and Maintenance (Minimum Annually)

IMPORTANT! Consult Approved for Construction Drawings and Anchor Manufacture Technical Manual (if applicable) before replacing fasteners, as most have specific design load requirements.

A. Frame, Sill Assembly:

1. Inspect components for damage and misalignment. Adjust, repair, or replace as needed, to meet original design tolerance.

B. Panel Assembly:

1. Inspect panel for corrosion or damage, repair or replace as necessary.
2. Inspect door panel alignment and free movement; clearance from ground/walking surface. Adjust door panel at trolley assembly using adjusting bolts as necessary.

C. Embedded Items:

1. Inspect all embedded components for corrosion, damage, and misalignment. Adjust, repair, or replace as needed, to meet original design tolerances.
2. Check all connections, making sure they meet original design standards (refer to Approved for Construction Drawings and Anchor Specifications).

D. Fasteners and mechanical connections:

1. All fasteners must be in place and adjusted to their original design standard, per included anchor manufacture technical manual (if applicable).
2. Ensure safety studs are in place and tight, repair or replace as necessary.
2. Replace any damaged components (refer to Approved for Construction Drawings and Anchor Specifications).

E. Top Roller Assemblies:

1. Inspect roller assemblies to ensure there are no flat spots on rollers, roller bearings are greased, and rollers operate freely, replace any damaged rollers as required.
2. Grease roller bearings via grease fitting with factory approved lubricants. Only using a general purpose grease rated for operating temperature of your geographical area and environmental conditions. Larger doors may use a permanently lubricated and sealed roller bearing, replace when bearing wears out.

F. Sealants and caulk:

1. Inspect all sealants used to ensure their effectiveness.
2. Replace any cracked, loose, and otherwise non-performing sealants.
3. Use only factory approved/supplied products (refer to Approved for Construction Drawings).
 - a. Factory approved sealant/waterstops: Sika; Sikaflex-227.

G. Weatherseals:

1. Inspect all weatherseals, and for continuous adhesion to the attached surface.
2. Visually inspect all gaskets for proper positioning, compression, and continuous contact with door panel.
3. Replace or repair if damage or deterioration to gaskets has occurred.
4. Use only factory approved materials (refer to Approved for Construction Drawings).

H. Handles:

1. Inspect all handles for wear, repair or replace as necessary.

I. Finishes:

1. Inspect all surfaces for signs of wear or corrosion and clean finishes periodically.
2. Touch up repair finishes, or refinish as necessary to protect the structural integrity.

J. Housekeeping:

1. Clean sill and jambs of any debris and keep the area clean throughout the operating area of the door including snow removal.
2. For all surfaces (Industrial Enamel, Epoxy, Powder Coat finishes, Stainless Steel):
 - a. Make a mixture of warm water and a gentle dish soap, using a soft cloth/rag, scrub the door and frame.
 - b. Rinse off with water and dry with paper towel.
3. Clean all gaskets and seals with a soft rag with warm water and dry off with paper towel.

K. Labels and Placards:

1. Inspect all labels and placards.
2. Replace any labels and placards which are unreadable/missing.

Inspection and Maintenance Log

CRITICAL Periodic Inspection and Maintenance Required. Inspect at minimum annually.

Date Installed:

Product:

Model Number:

Serial Number:

Opening Identifier/ Number:

Location:

DATE INSPECTED	INSPECTED BY <i>(Print & Sign)</i>	INSPECTION ITEMS NOTED	CORRECTIVE ACTION	CORRECTED BY <i>(Print & Sign)</i>

Inspection and Maintenance Log

CRITICAL Periodic Inspection and Maintenance Required. Inspect at minimum annually.

Date Installed:

Product:

Model Number:

Serial Number:

Opening Identifier/ Number:

Location:

DATE INSPECTED	INSPECTED BY <i>(Print & Sign)</i>	INSPECTION ITEMS NOTED	CORRECTIVE ACTION	CORRECTED BY <i>(Print & Sign)</i>

PS INDUSTRIES® INCORPORATED – LIMITED WARRANTY

Limited Warranty: Subject to the terms of this Limited Warranty, PS Industries® Incorporated warrants to the original user or consumer (the "Owner") of a PS Industries product (the "Product") that, for a period of five (5) years from date of shipment, the Product will be free from defects in material and workmanship under normal use and service, and provided the Product is installed, operated and maintained in accordance with instructions supplied by PS Industries. The terms and limitations of this Limited Warranty apply to all repaired or replacement Products for a term equal to the balance of the warranty remaining on the Product that was repaired or replaced as of the date of such repair or replacement.

PS Flood Barriers™ Product Warranty Registration: For PS Flood Barriers™ Products, this Limited Warranty will only be valid if the Owner completes the Warranty Registration Form provided within thirty (30) days of Product installation. To request a copy of the Warranty Registration form, contact PS Industries, 1150 S. 48th Street, Grand Forks, ND 58201, phone 877-446-1519, email: 4psinfo@psindustries.com. Register online at: www.psindustries.com/contact/register-your-product/ Additional Warranty Registration Forms can be downloaded at www.psfloodbarriers.com/download-center/

Warranty Exclusions: Notwithstanding anything to the contrary, this Limited Warranty does not cover any of the following:

1. Normal wear and tear (including, but not limited to, normal wear and tear to gaskets and weather seals); damage or accidents resulting from freight damage, from failure to follow precautionary safety measures, or applied paint failure; abuse, misuse or unauthorized modification of the Product; misapplication; improper installation; or any defects, damage or other harm that is not the result of the acts or omissions of PS Industries.
2. Cost of field labor or other charges incurred by Owner in removing and/or re-affixing the Product or any part or component thereof.
3. Transportation costs.

Unauthorized modification of or to the Product voids this Limited Warranty. Authorized modifications, received in writing from PS Industries, as long as the modification is accomplished in strict accordance with PS Industries' instructions, does not void warranty. To request product modifications contact PS Industries, 1150 S. 48th Street, Grand Forks, ND 58201, phone 877-446-1519, email: 4psinfo@psindustries.com.

Claim Procedure: To make a claim under this Limited Warranty, the claim must be received by PS Industries before the expiration of the above stated Limited Warranty period together with proof of purchase. Contact PS Industries at the address shown below.

PS Industries Incorporated	Toll Free: 877-446-1519
Attention: Warranty	Phone: 701-746-4519
1150 S. 48th Street	Fax: 701-746-8340
Grand Forks, ND 58201	E-mail: 4psinfo@psindustries.com

An authorized PS Industries Incorporated representative must be given a reasonable opportunity to inspect and investigate the alleged Product defect prior to any work being done that affects the Product or its installation. PS Industries reserves the right to charge reasonable amounts for travel and labor associated with investigation of claims. PS Industries may also require photographs of the alleged Product defect or return of the Product or part to a designated PS Industries location, freight prepaid. A return goods authorization must be received prior to the return of the Product or part. Please contact PS Industries to determine the designated location for return and to obtain the return material authorization.

Exclusive Remedy: In the event of a warranty claim that PS Industries determines to be covered by this Limited Warranty, PS Industries will replace or repair, at PS Industries' discretion, the Product or any part of the Product found to be defective.

Disclaimers: The above warranty and remedy is the sole express warranty and remedy given by PS Industries on its Product. No warranties or representations at any time made by any representative from PS Industries shall vary or expand the provisions hereof. TO THE EXTENT PERMITTED BY LAW, ALL EXPRESS AND IMPLIED WARRANTIES (INCLUDING IMPLIED WARRANTIES OF MERCHANTABILITY, FITNESS FOR A PARTICULAR PURPOSE AND NON-INFRINGEMENT) OTHER THAN THE EXPRESS LIMITED WARRANTY SET FORTH ABOVE ARE EXPRESSLY DISCLAIMED. UPON THE EXPIRATION OF THE ABOVE STATED LIMITED WARRANTY PERIOD, ANY AND ALL APPLICABLE IMPLIED WARRANTIES, INCLUDING, WITHOUT LIMITATION, WARRANTIES OF MERCHANTABILITY, FITNESS FOR A PARTICULAR PURPOSE AND NON-INFRINGEMENT, ARE DISCLAIMED. SOME STATES DO NOT ALLOW LIMITATION ON HOW LONG AN IMPLIED WARRANTY LASTS, SO THE ABOVE LIMITATION MAY NOT APPLY TO OWNER.

LIABILITY LIMITATION: In no event will PS Industries' liability to Owner or any other person or entity exceed the price paid to PS Industries for the defective Product. IN NO EVENT SHALL PS INDUSTRIES BE LIABLE TO OWNER OR ANY OTHER PERSON OR ENTITY FOR INCIDENTAL, CONSEQUENTIAL, INDIRECT OR SPECIAL DAMAGES OF ANY DESCRIPTION, WHETHER ARISING OUT OF WARRANTY (INCLUDING ANY IMPLIED WARRANTIES) OR ANY OTHER CONTRACT, STRICT LIABILITY, NEGLIGENCE OR OTHER TORT, OR OTHERWISE, INCLUDING ARISING FROM INSPECTION OR REMEDY DELAYS. SOME STATES DO NOT ALLOW THE EXCLUSION OR LIMITATION OF INCIDENTAL OR CONSEQUENTIAL DAMAGES, SO THE ABOVE LIMITATION AND EXCLUSION MAY NOT APPLY TO OWNER.

THIS WARRANTY GIVES OWNER SPECIFIC LEGAL RIGHTS AND OWNER MAY ALSO HAVE OTHER RIGHTS, WHICH VARY FROM STATE TO STATE.



877.446.1519

4psinfo@psindustries.com | psaccesssolutions.com

1150 South 48th Street | Grand Forks, ND 58201

Product Registration:

psindustries.com/contact/register-your-product